

# Porsche Boxster/Cayman Workshop Manual

SAMPLE

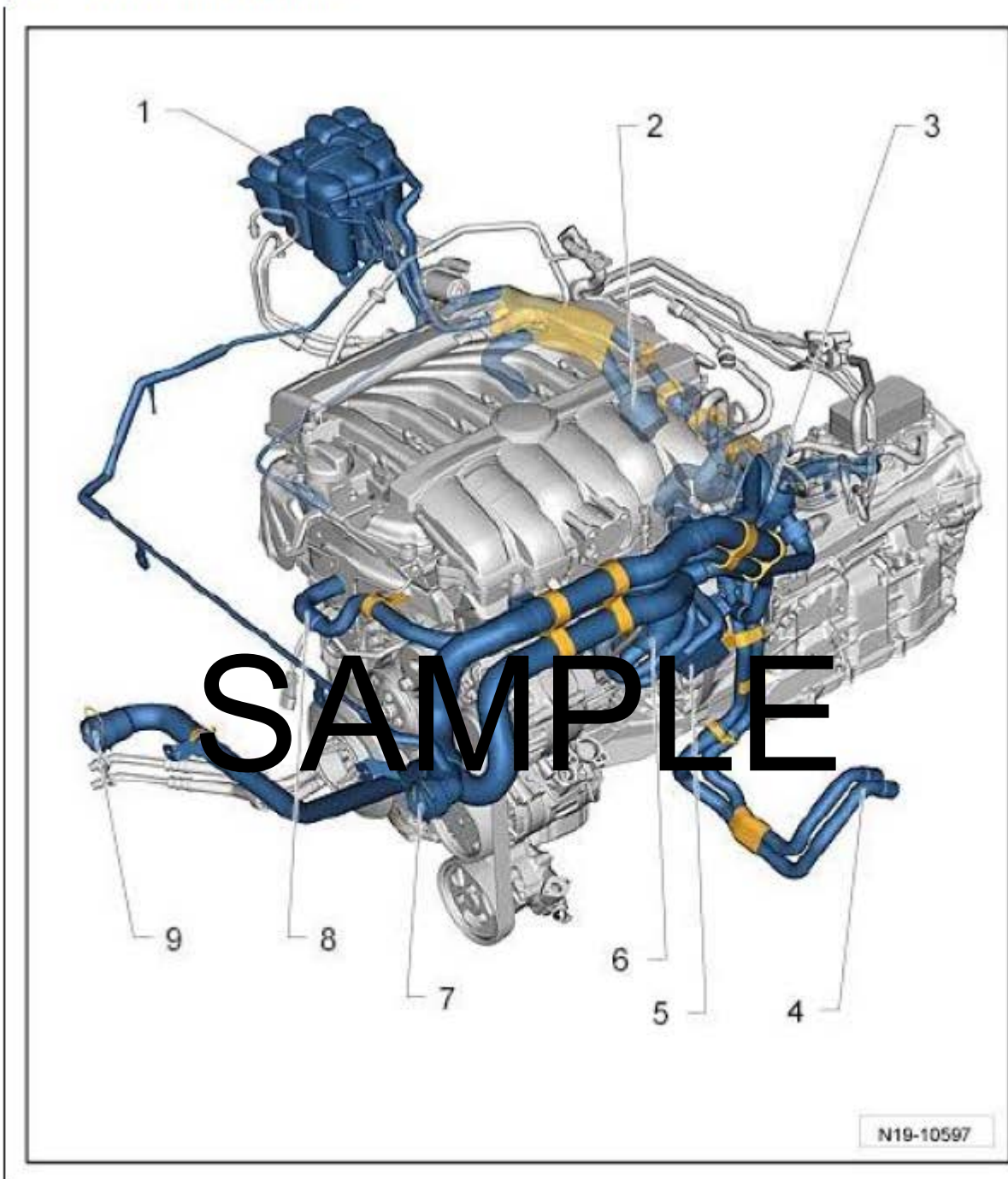

Fig 1: Overview Of Cooling System



Courtesy of PORSCHE CARS NORTH AMERICA, INC.

1. Coolant Reservoir
2. Circulating Pump
3. Shut-Off Valve For Heat Exchanger For Heater
4. Hoses For Heat Exchanger For Heater

Fig 1: Removing/Installing Fuel Pressure Sensor (Low-Pressure Sensor)

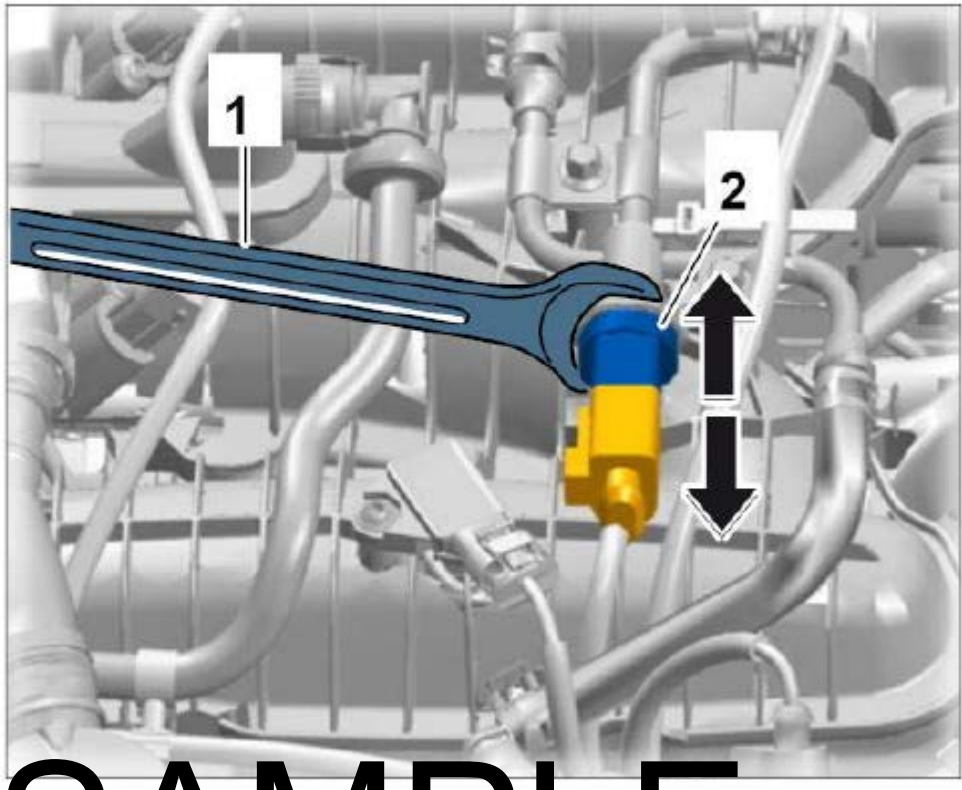

Courtesy of PORSCHE CARS NORTH AMERICA, INC.

# SAMPLE

## WM 240919 REMOVING AND INSTALLING FUEL PRESSURE SENSOR (LOW-PRESSURE SENSOR) (CAYENNE S & CAYENNE GTS) > INSTALLING FUEL PRESSURE SENSOR (LOW-PRESSURE SENSOR)

**⊗** **WARNING:** *Toxic substances*

- *Danger of poisoning or suffocation*
- *Danger of burns to the eyes and skin*

- Ventilate the work area well.
- Never ingest or inhale.
- Read specific information on the Hazard Sheet.
- Do not smoke, eat or drink in the work area.

**ACCESSORIES & EQUIPMENT**

**Door Front, Central Locking System**

**57 09 19 REMOVING AND INSTALLING LOCK CYLINDER**

**REMOVING LOCK CYLINDER**

Removing lock cylinder

Installation Location:

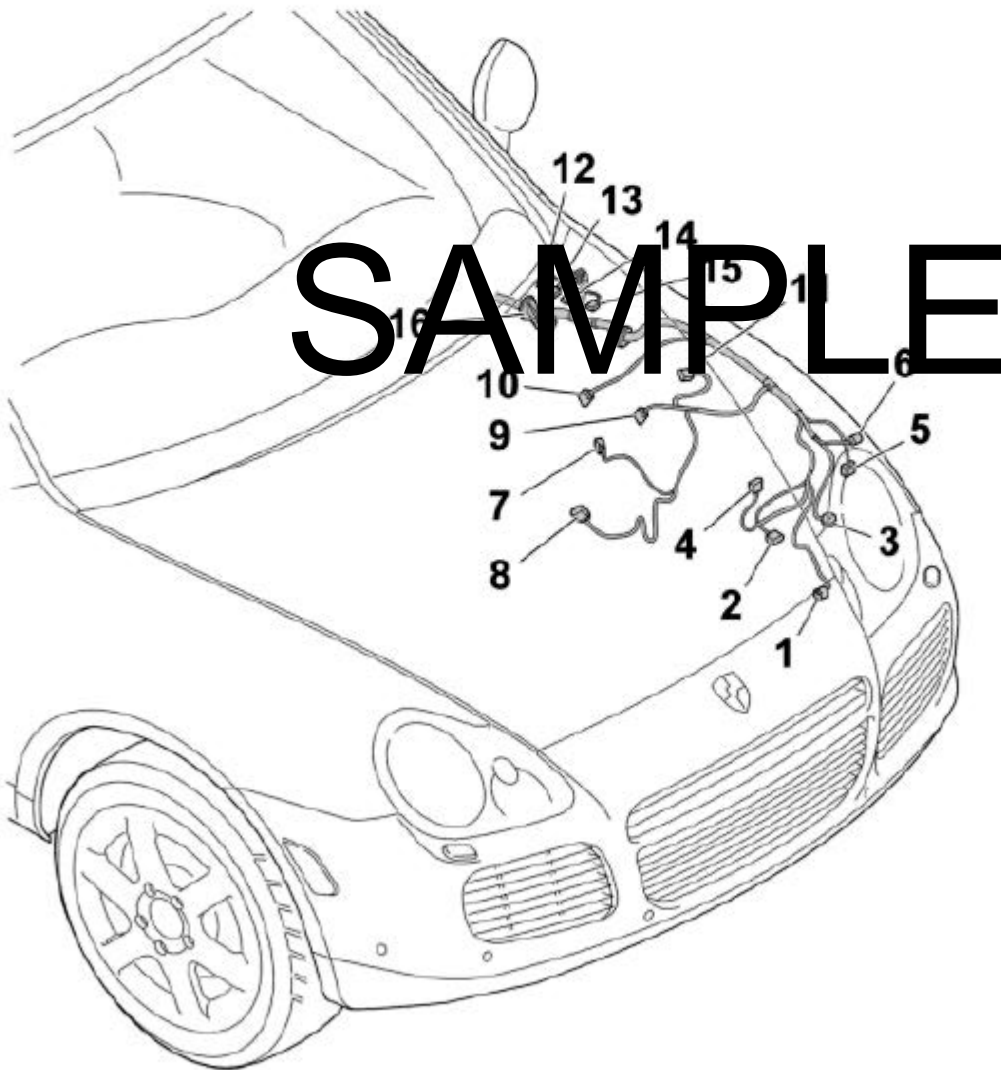

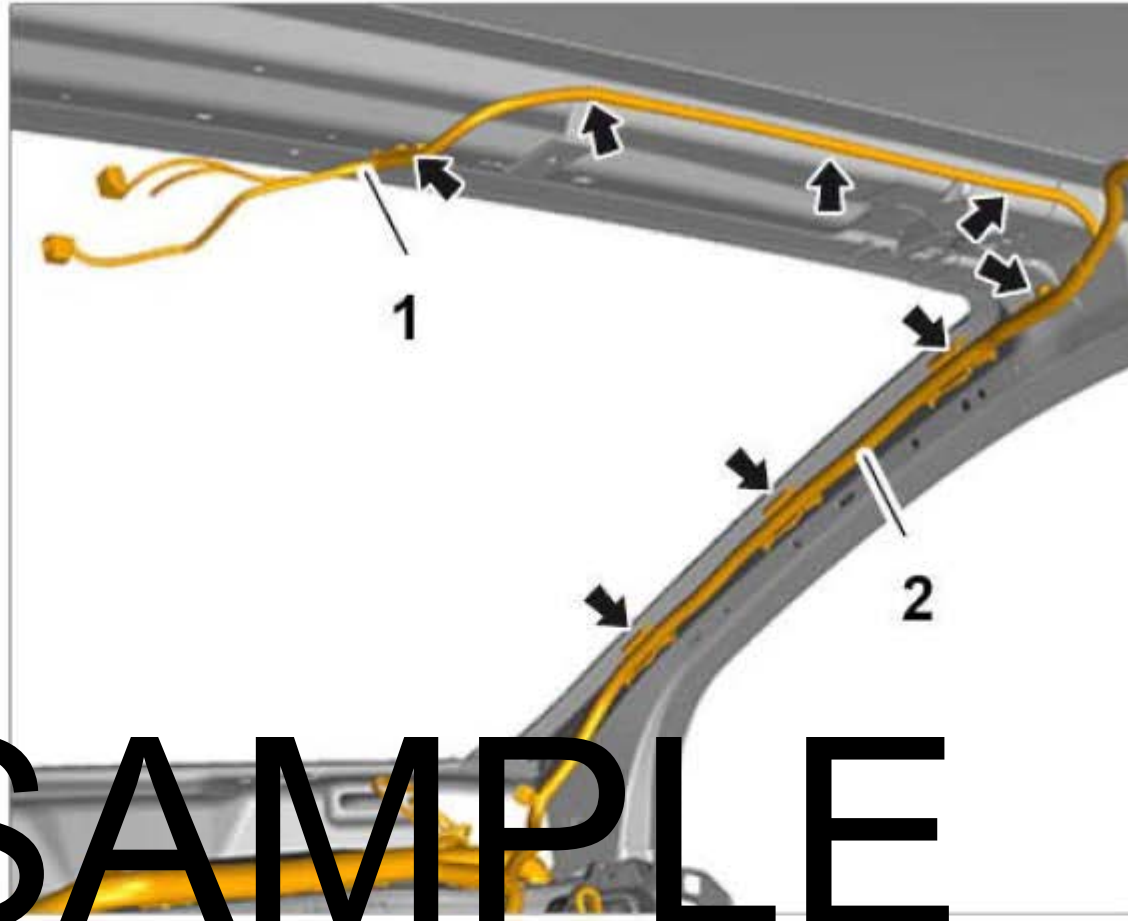

SAMPLE

Fig. 10: Locating Roof Console Section Line  
Courtesy of PORSCHE CARS NORTH AMERICA, INC.

11. Unclip section of line -1- on the roof pillar at the right.

Fig 4: Levering Out Brake Pedal

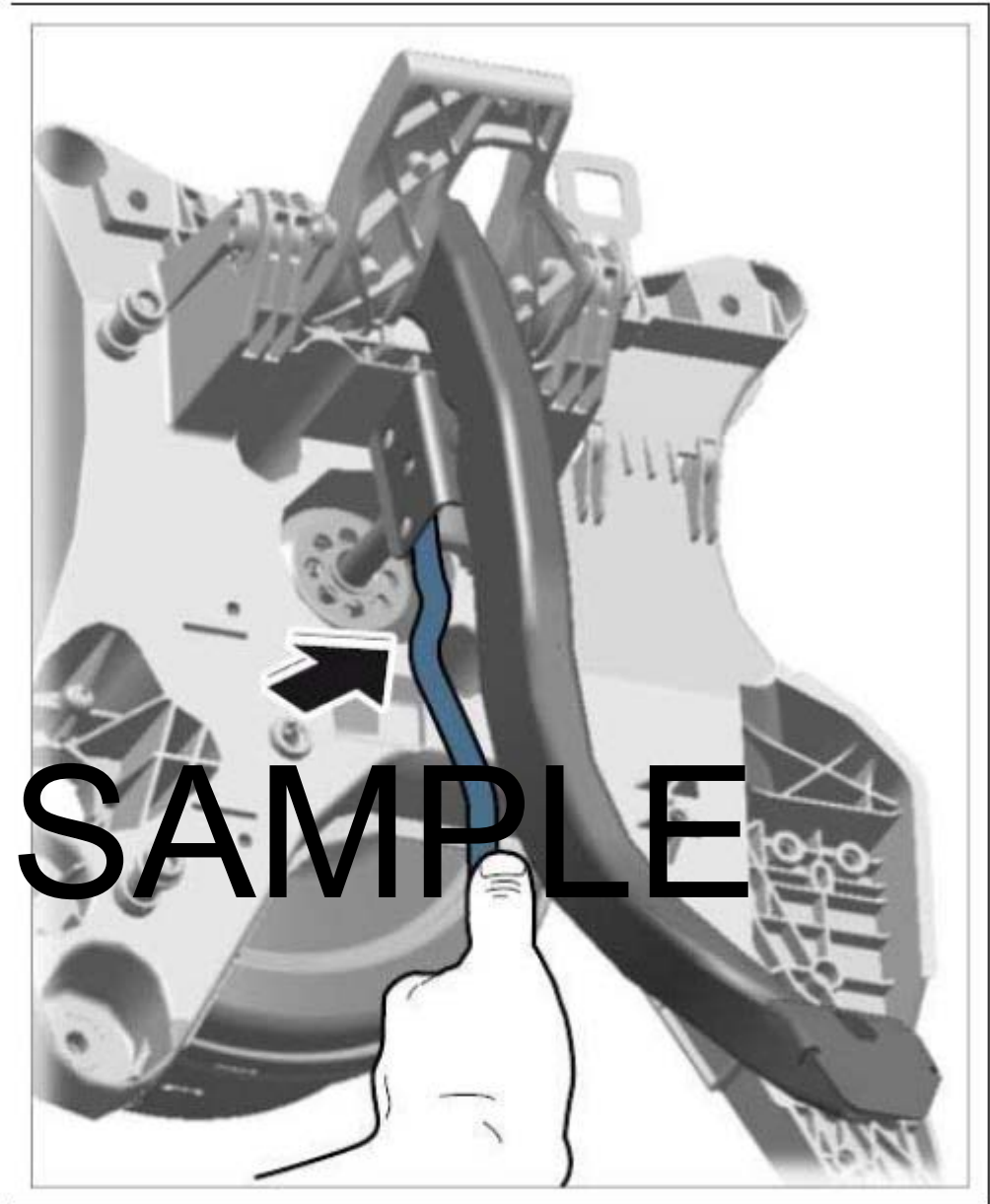

Courtesy of PORSCHE CARS NORTH AMERICA, INC.

3. 1.3. When pressing Release Tool T10189 in direction of travel, the brake pedal mounting is pressed apart and the ball of the push rod is released. At the same time, pull the brake pedal away from the direction of travel and release the brake pedal from the push rod.

Air cleaner for carbon canister to wheel arch. → **Tightening torque: 5 Nm (3.5 ftlb.)**

Cover for fuel line to body. → **Tightening torque: 8 Nm (6 ftlb.)**

## GROUP 21

### Turbocharger

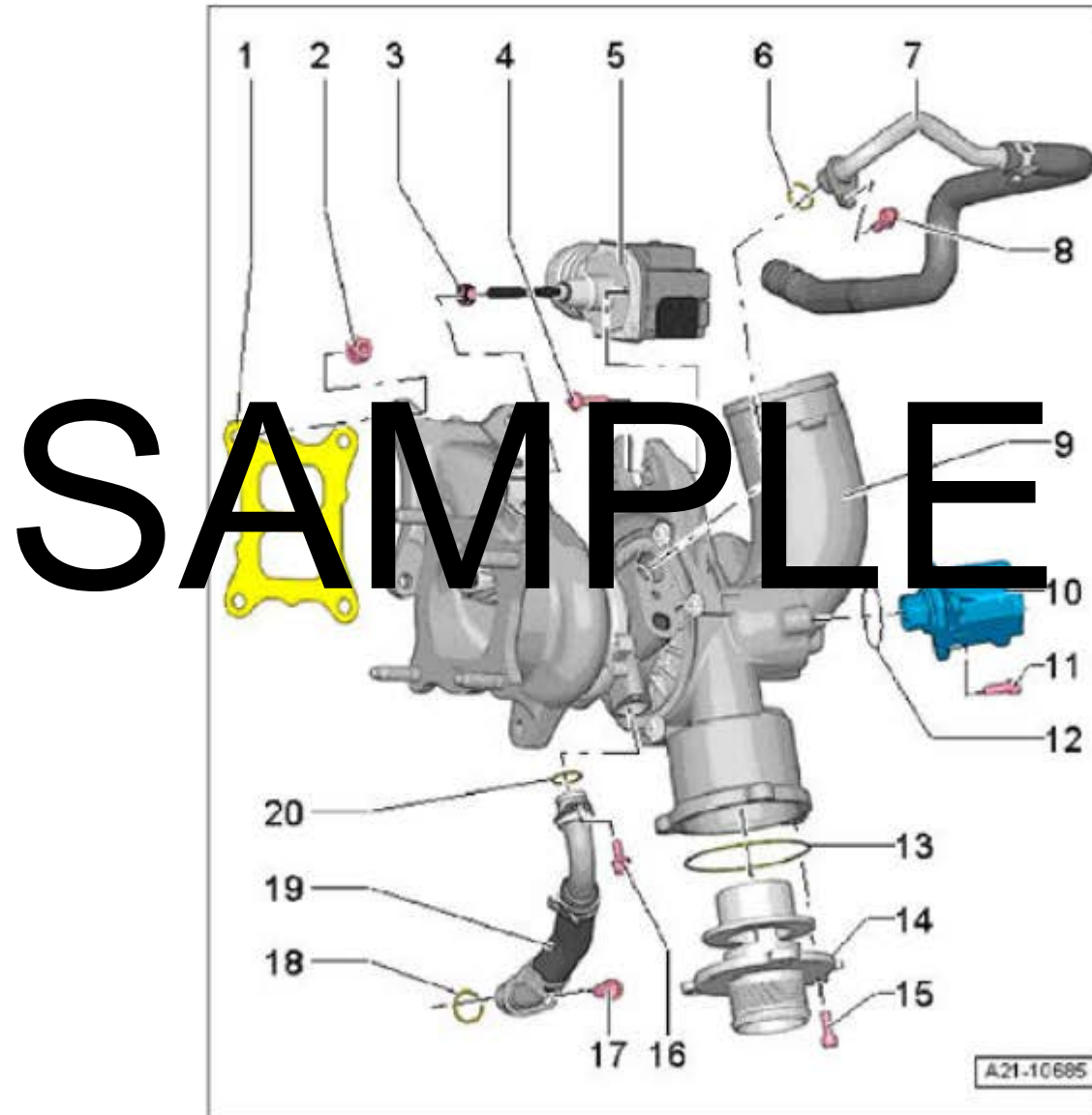

**Fig. 1: Identifying Turbocharger Components**

Courtesy of PORSCHE CARS NORTH AMERICA, INC.

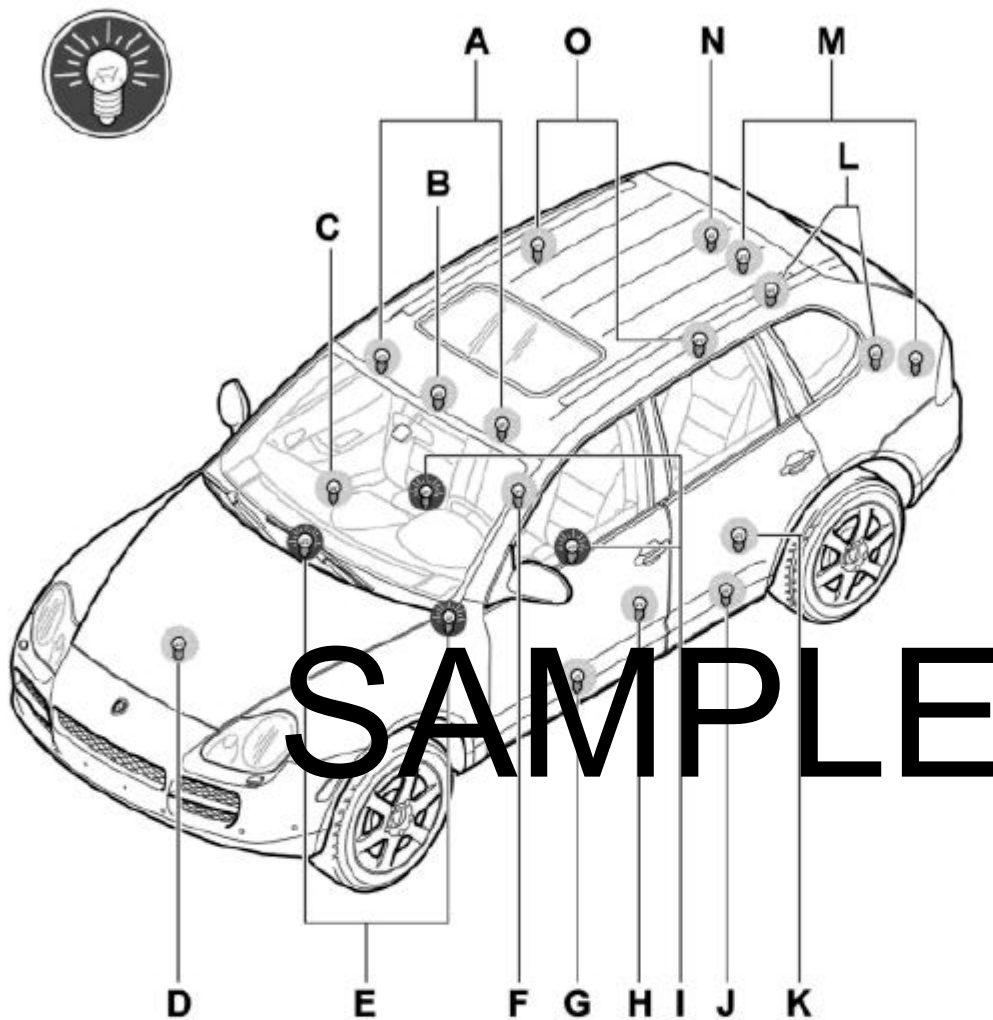

**Fig. 16: Bulb location overview**  
Courtesy of PORSCHE OF NORTH AMERICA, INC.

-E- - Front floor light. See [Fig. 16](#).

-I- - Rear floor light. See [Fig. 16](#).

#### REMOVING BULB FOR FLOOR LIGHT

1. Switch off ignition and remove ignition key.



### Changing engine oil (without filter)

**Precondition:** Engine at operating temperature (70...90° C oil temperature)

1. Remove engine guard and right-hand side member panel. Undo the drain plugs in the crankcase and thermostat housing and drain engine oil.

Crankcase drain plug



606-03

Thermostat housing drain plug

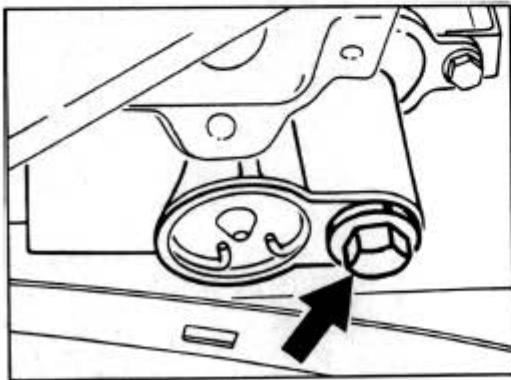

1454-03

2. Clean drain plugs. Always replace the seals. **Tightening torque of drain plugs is 50 Nm (37 ftlb.):**  
**at the thermostat housing**  
**50 + 5 Nm (37 + 3.7)**  
**at the crankcase 50 + 5 Nm (37 + 3.7)**
3. Fill with approx. 6 liters of engine oil. Run engine at idle and top up with approx. 3 liters. The oil change capacity is approx. 9 liters. Use only approved engine oils. Refer to Technical Information Handbook.

Check oil level at operating temperature and at idle speed (refer to Owner's Manual).  
 Check engine, oil reservoir, lines and front oil cooler for leaks (visual inspection)!

SAMPLE

**10 01 37 Dismantling and assembling crankcase sections****Left-hand crankcase section**

**Note: Unless indicated otherwise, apply Loctite 270 to all stud threads when reassembling the engine!**

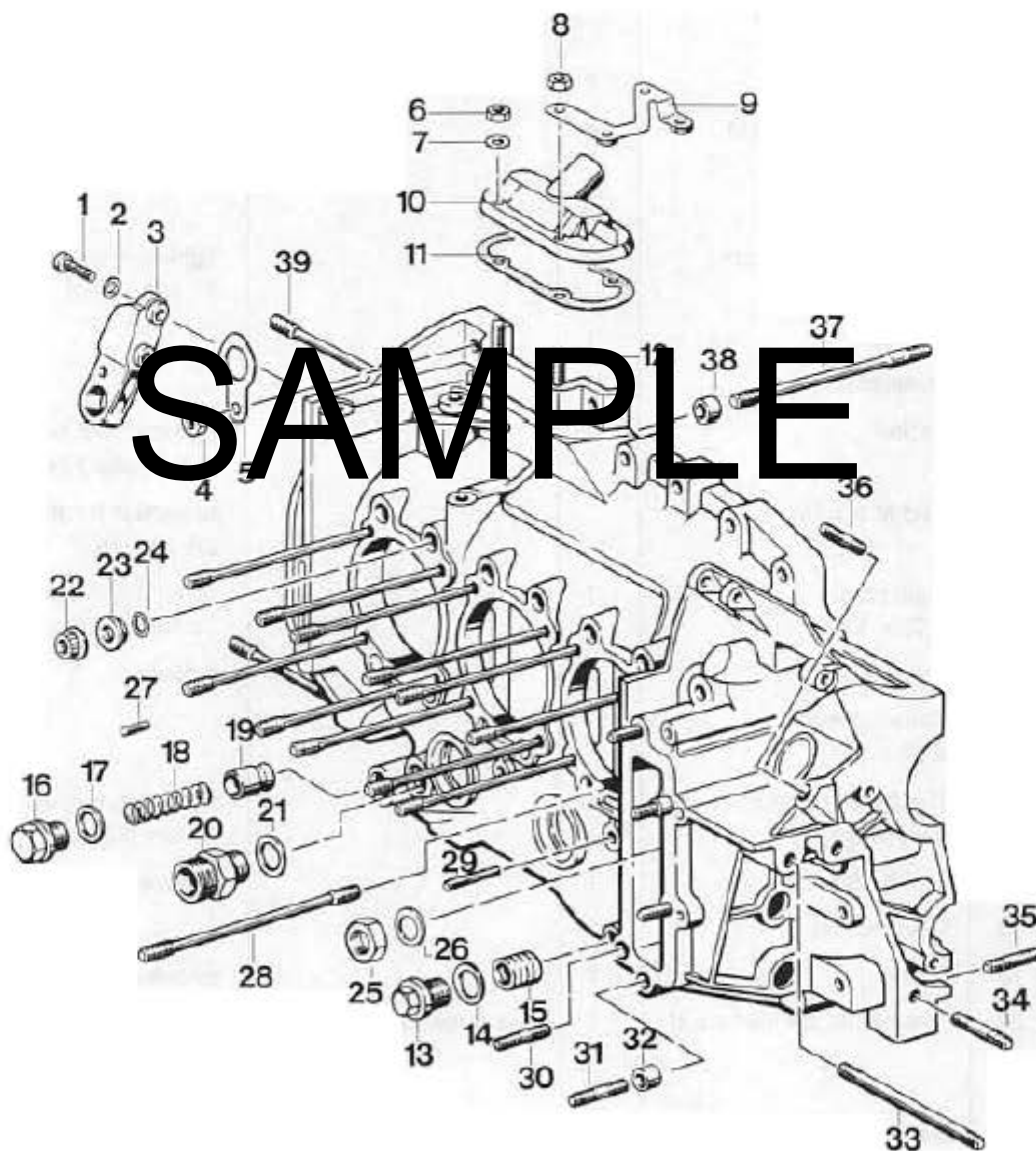

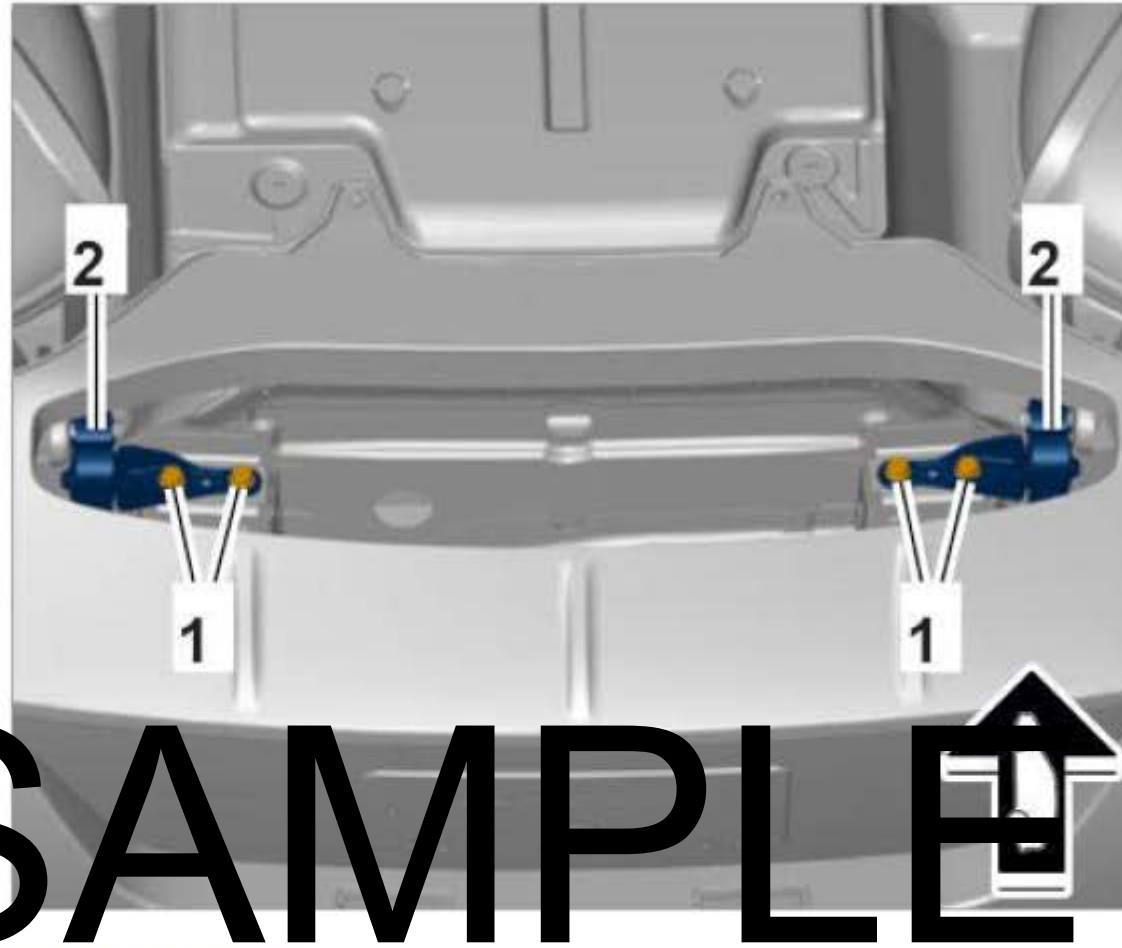

**Fig. 9: Identifying Rear Silencer Holder Screws**

Courtesy of PORSCHE CARS NORTH AMERICA, INC.

5. Remove rear silencer by pulling it downwards.
6. De-burr cut on inside and outside of the exhaust pipe. If necessary, remove rust from exhaust pipe using suitable polishing agents and manually restore its round shape.
7. Convert rear holder for rear silencer.
  - 7.1. Fit new support rubbers or holders if necessary.
8. Push new clamping sleeve onto the exhaust pipe.
9. Lift the rear silencer into installation position with the help of another person or a transmission jack. Tighten two fastening screws on each holder to the specified tightening torque.
  - 9.1. Tightening torque for screws securing holder for rear silencer to rear body:
10. Position clamping sleeves -**arrows**- in the center of the cutting point during installation.

Fig 2: Automatic A/C Circuit (2 of 5)

