

# REAR SPOILER

## ADHESIVE

Application	Brand
Rear spoiler	Double-sided tape [15 mm width 1.2 mm thickness, 30 mm width 1.2 mm thickness]

## REAR SPOILER

### REMOVAL AND INSTALLATION

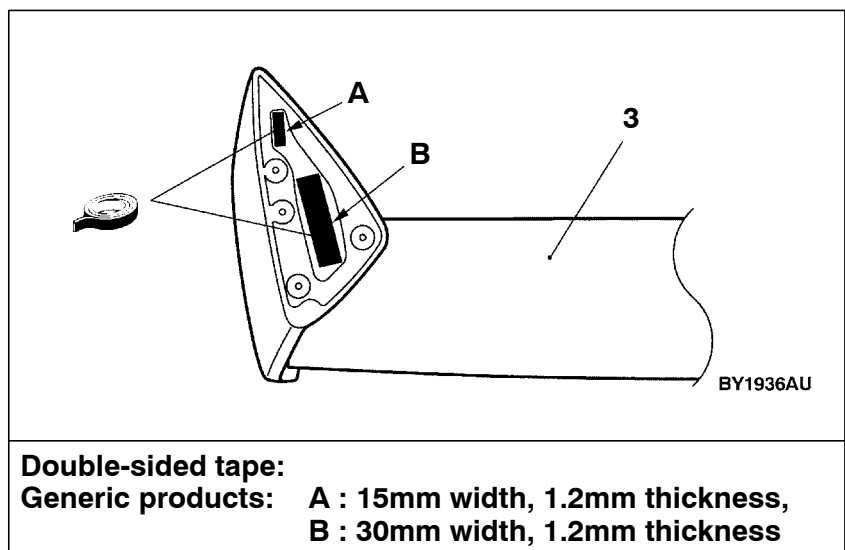
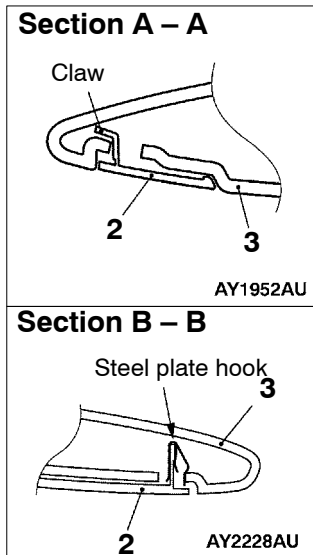
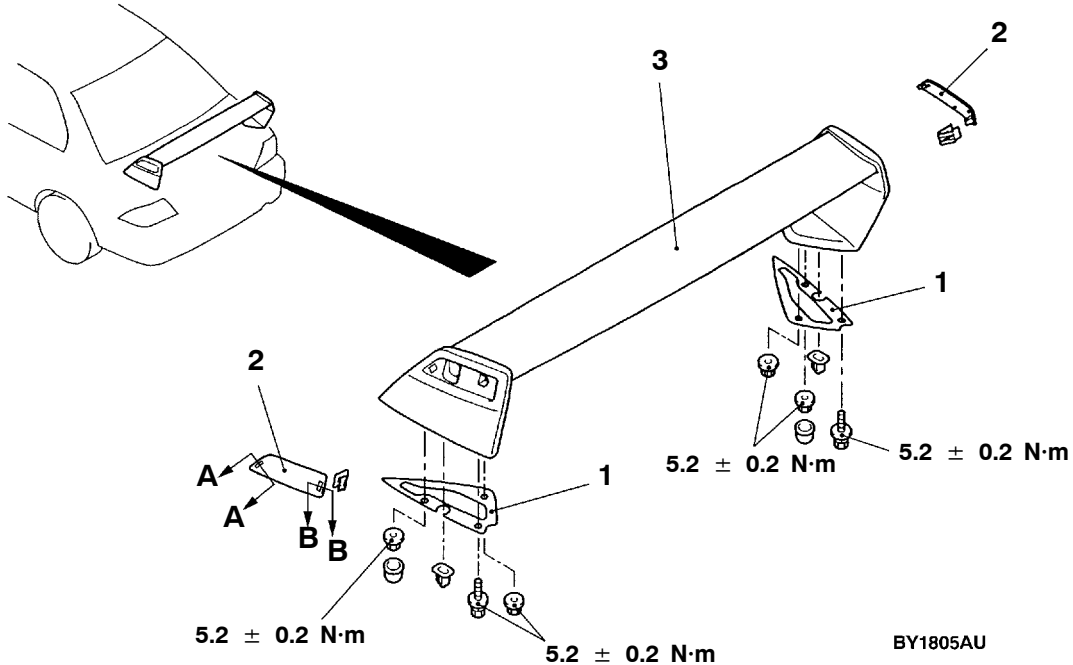

**Removal steps**

- Trunk lid bumper (Refer to Group 42.)
- 1. Gasket
- 2. Cap
- 3. Rear spoiler

**NOTE:**

The removal and installation service points are the same as SIDE AIR DAM , MOLDING AND GARNISH. (Refer to P.51-10)



# WINDSHIELD WIPER AND WASHER

## SERVICE SPECIFICATIONS

Item	Standard value
Stop position of the windshield wiper arm/blade assembly (distance between the edge of the wiper blade and the end of the deck garnish) mm	34 ± 5

## TROUBLESHOOTING

The windshield wiper-washer is controlled by the smart wiring system (SWS). Refer to Group 54B for troubleshooting.

### NOTE

If ETACS-ECU is faulty, the windshield wiper can be operable in LO mode only as the fail-safe function. (Normally the windshield wiper is operable when the ignition switch is turned to the ACC position. When the fail-safe function is enabled, it is operable only when the ignition switch is turned to the ON position.)

## ON-VEHICLE SERVICE

### WINDSHIELD INTERMITTENT WIPER INSPECTIONS

- (1) Check the change in the intermittent time of the wiper operation by using the windshield intermittent wiper volume.
- (2) Carry out troubleshooting if any of them is faulty. (Refer to Group 54B.)

# WINDSHIELD WIPER AND WASHER

## REMOVAL AND INSTALLATION

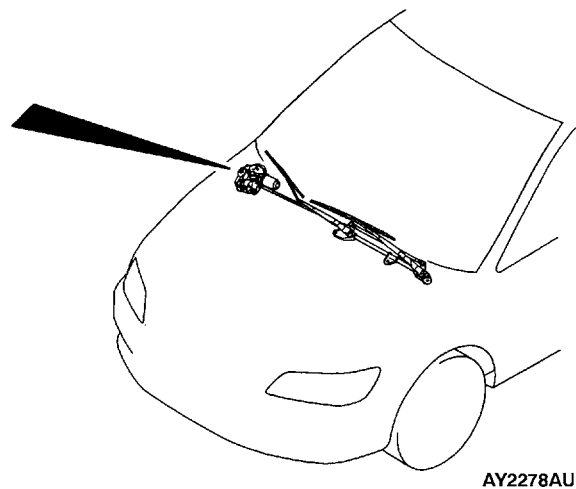
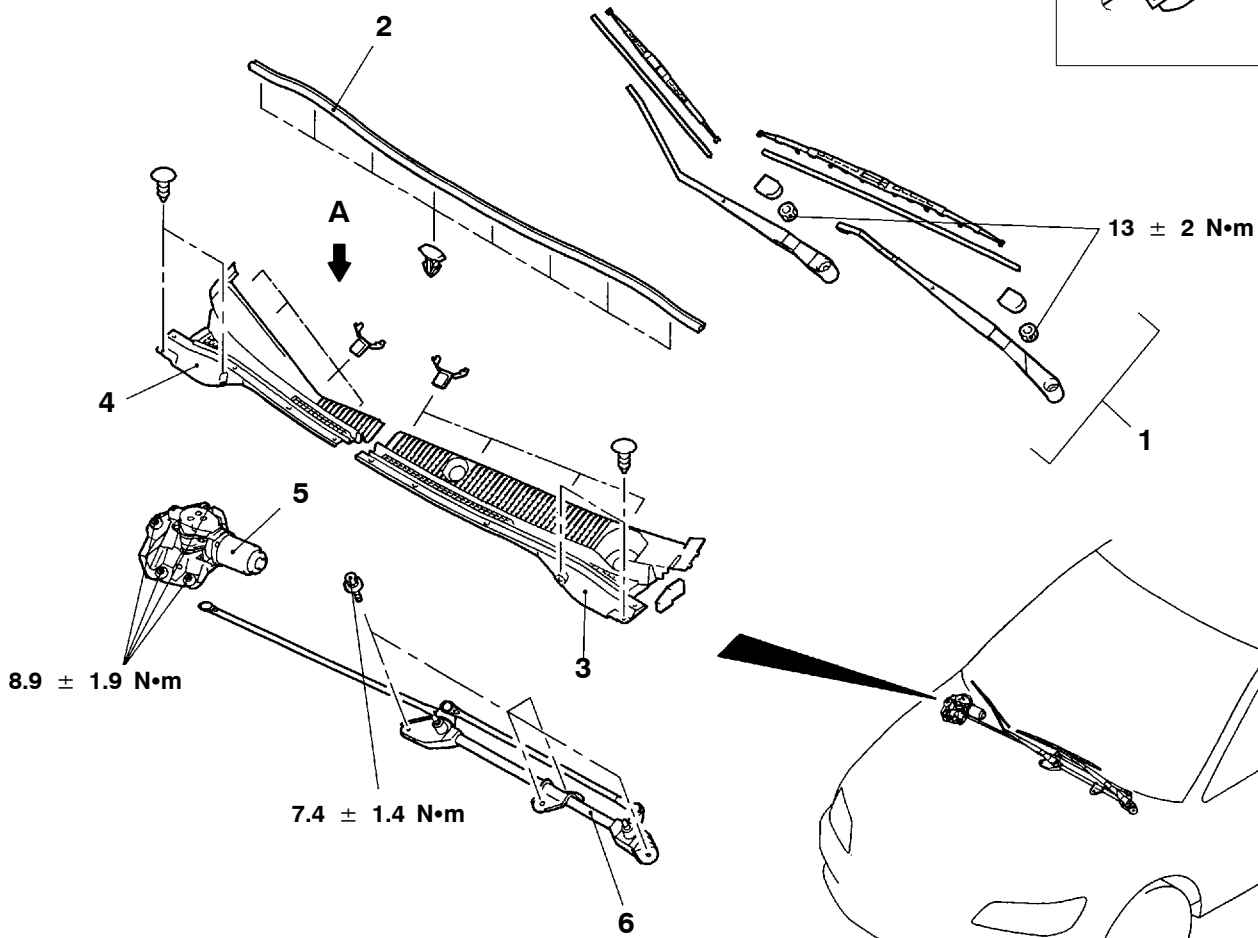
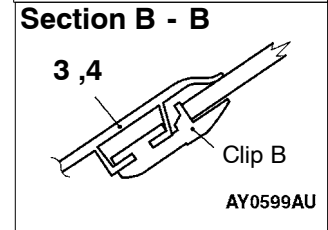
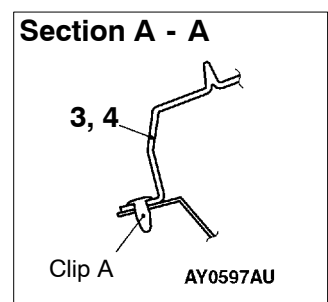
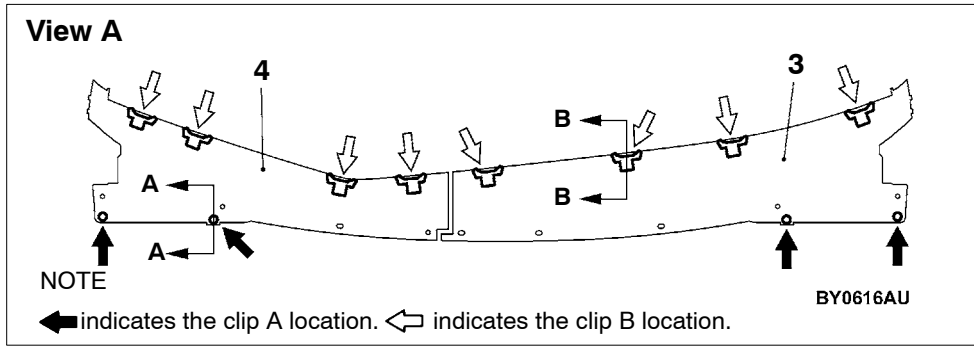

### Windshield wiper motor assembly and link assembly removal steps



1. Wiper arm/blade assembly
2. Hood weather strip
3. Front deck garnish (driver's side)



4. Front deck garnish (passenger's side)
5. Windshield wiper motor assembly
6. Link assembly

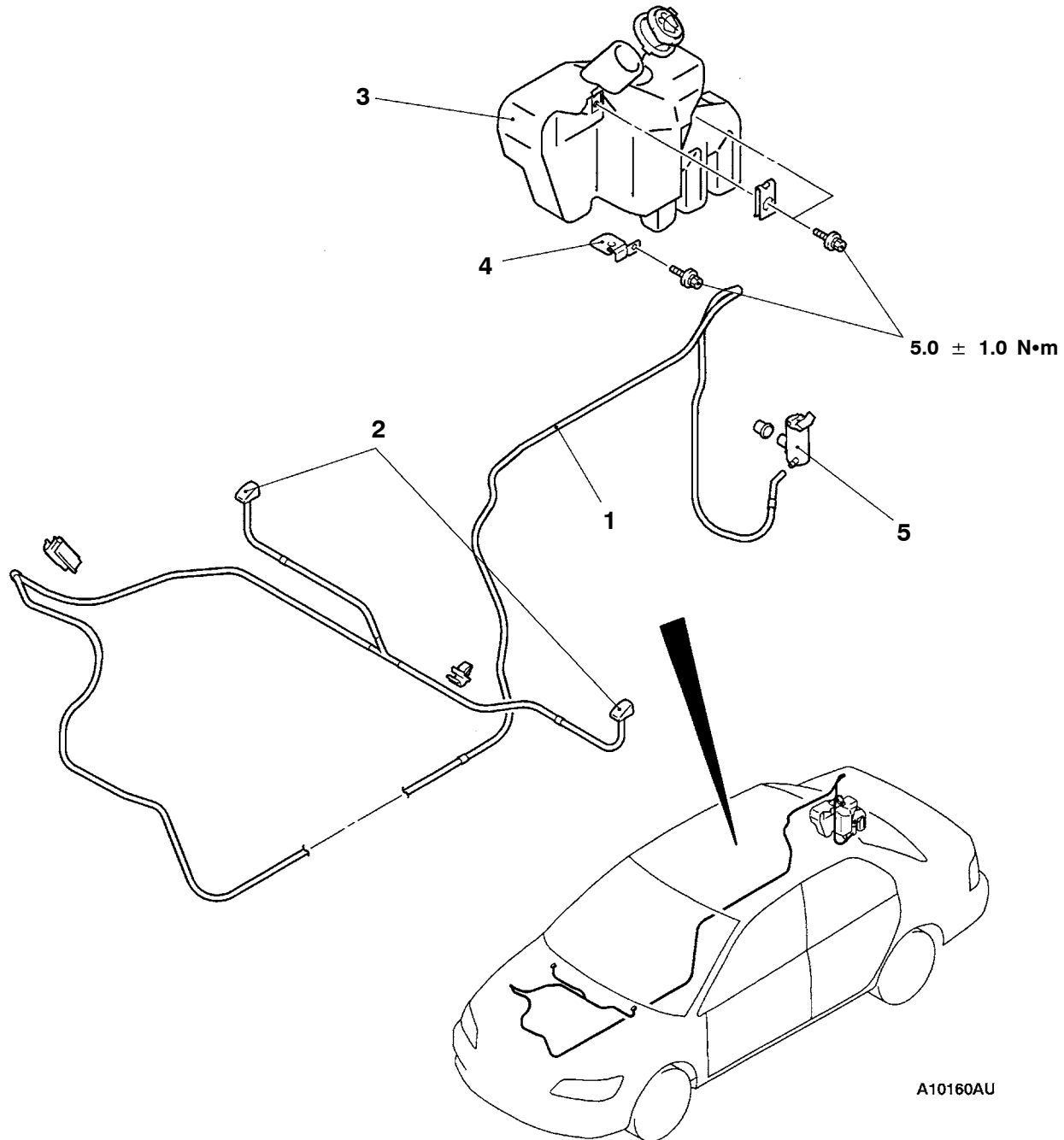

A10160AU

NOTE: Refer to P.51-19 for more information regarding removal and installation of rear washer nozzle.

#### Washer hose removal steps

- Splash shield <Right side> (Refer to GROUP 42 – Fender.)
  - Cowl side trim, front scuff plate, center pillar trim, lower, rear scuff plate (Refer to GROUP 52A – Trim.)
  - Rear seat (Refer to GROUP 52A – Seat.)
1. Washer hose

#### Windshield washer nozzle removal steps

- Connection of washer hose
2. Windshield washer nozzle

#### Washer tank and windshield washer motor assembly removal steps

- Rear end trim, trunk side trim (Refer to GROUP 52A – Trim.)
  - Connection of front washer hose
3. Washer tank assembly
  4. Washer tank bracket
  5. Washer motor

NOTE: Refer to GROUP 54A– Column Switch for removal and installation of wiper washer switch.

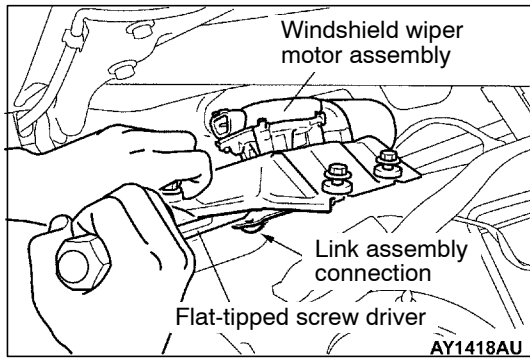

## REMOVAL SERVICE POINT

### ◀A▶ WINDSHIELD WIPER MOTOR ASSEMBLY REMOVAL

1. Remove the windshield wiper motor assembly mounting bolt.
2. Use the flat-tipped screw driver to disengage the link between the windshield wiper motor assembly and the link assembly to remove the windshield wiper motor assembly.

#### Caution

**Be careful not to damage the windshield glass when the windshield wiper motor assembly is removed.**

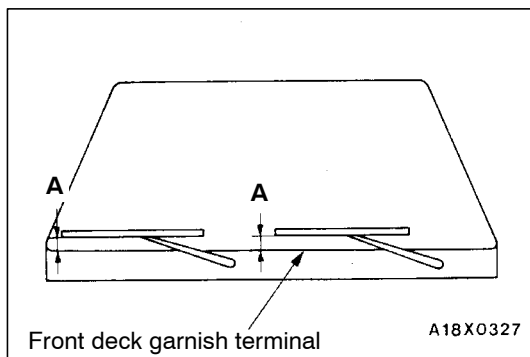

## INSTALLATION SERVICE POINT

### ▶A◀ WIPER ARM/BLADE ASSEMBLY INSTALLATION

Assemble the parts so that the edge of the wiper blade can stop in the specified position (standard value).

**Standard value:(A)  $34 \pm 5$  mm**

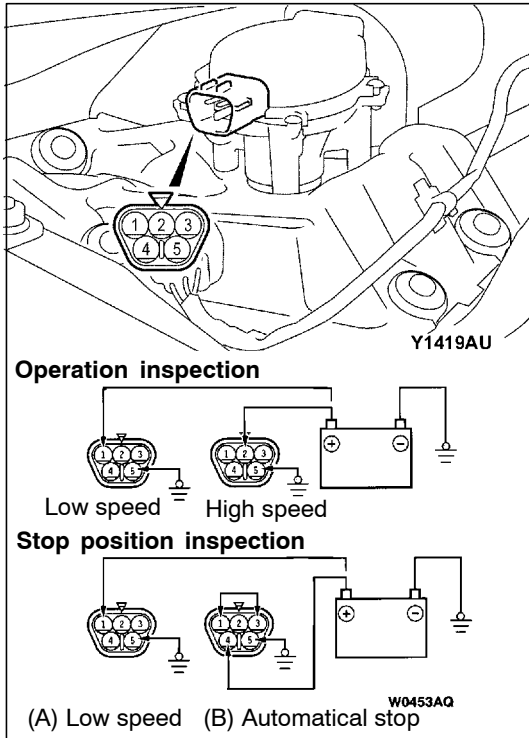

## INSPECTIONS

### WINDSHIELD WIPER MOTOR CHECK

Inspection of windshield wiper motor is conducted by removing the harness connector with the motor attached to the vehicle.

- **Operation inspection of windshield wiper motor rotation in a low or high speed**

Connect the battery to the windshield wiper motor to inspect the operation of motor rotation in a low or high speed.

- **Inspection of windshield wiper motor stop position**

(1) Connect the battery to the windshield wiper motor to rotate the motor in a low speed as shown in the illustration (A) and disconnect the battery during rotation to stop the motor.

(2) Connect between the terminals and the battery as shown in the illustration (B) and confirm whether the motor stops at the automatic stop position after rotating in a low speed.

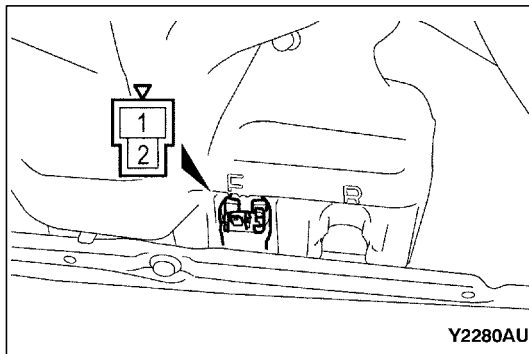

### FRONT WASHER MOTOR CHECK

(1) The inspection of front washer motor is conducted with the washer hose connected after removing the washer tank assembly and pouring water in the washer tank.

(2) Check that the water is supplied with strong pressure after energizing terminal number 2 with battery voltage and earthing terminal number 1.

**WINDSHIELD WASHER NOZZLE INJECTION POSITION CHECK**

Move the nozzle to adjust the position so that the injection can be done in an area shown in the illustration.

**Caution**

**On R.H. drive vehicles, the illustration is symmetrical.**

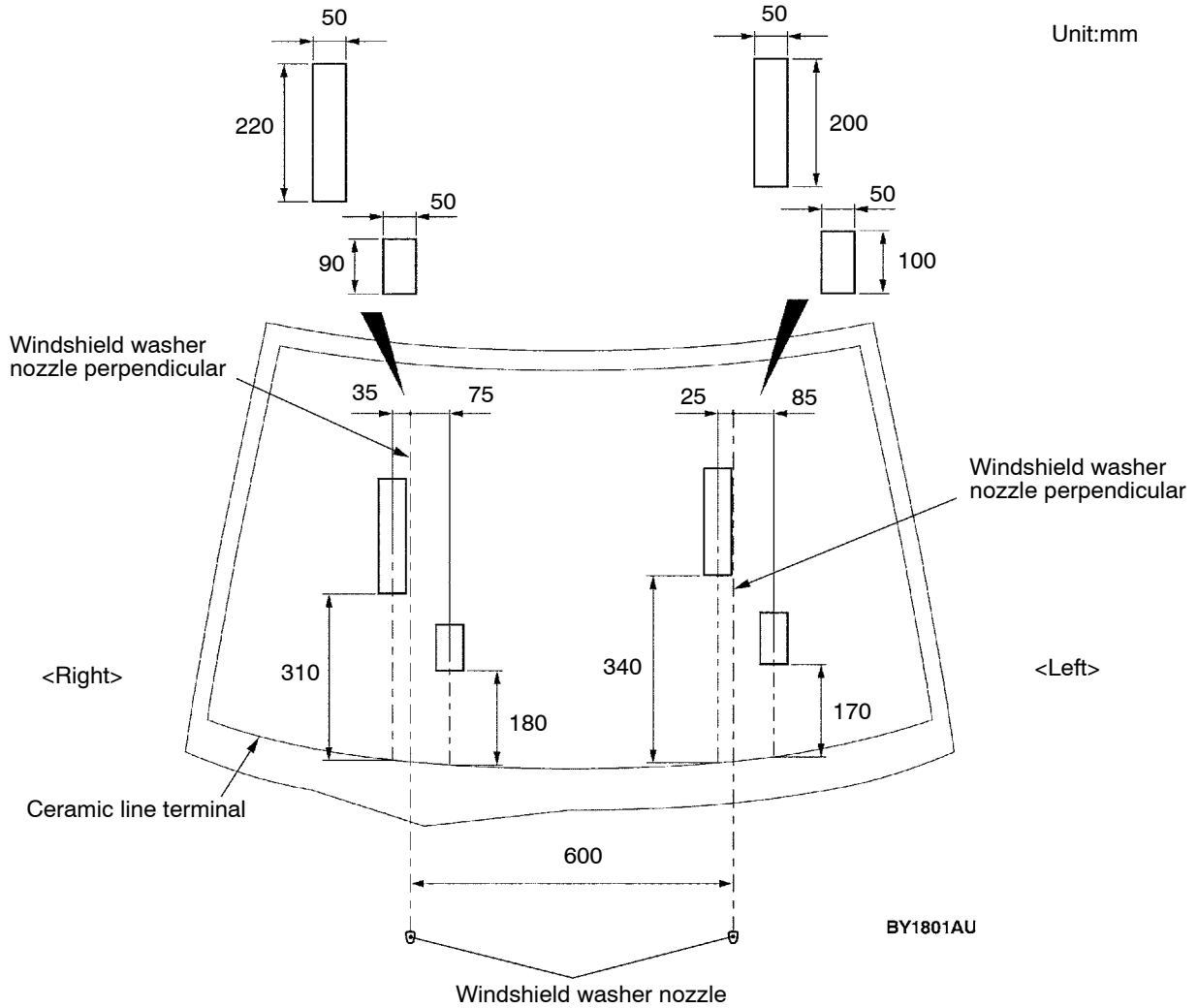

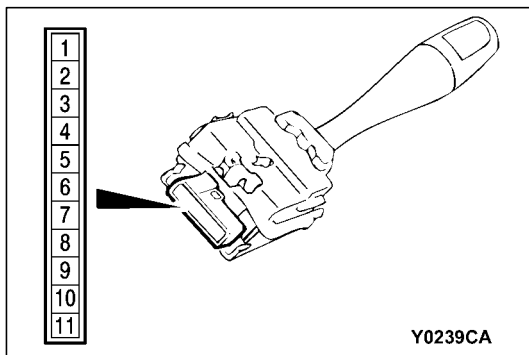

**WINDSHIELD WIPER AND WINDSHIELD WASHER SWITCH AND WINDSHIELD INTERMITTENT WIPER INTERVAL ADJUSTING KNOB CHECK**

<L.H.drive vehicles>

- (1) Windshield wiper and washer switch, rear wiper and washer switch.

Switch position	Terminal No.					
	6	7	8	9	10	11
OFF						
Windshield wiper mist switch ON	○					○
Windshield intermittent wiper switch ON	○				○	
Windshield low-speed wiper switch ON	○			○		
Windshield high-speed wiper switch ON	○		○			
Windshield washer switch ON	○	○				

- (2) Windshield intermittent wiper interval adjusting knob  
Measure the resistance value at terminal numbers 3 and 6. The resistance value should rise smoothly from approximately 0 Ω (“FAST” position) to apporoximately 1 kΩ (“SLOW” position).

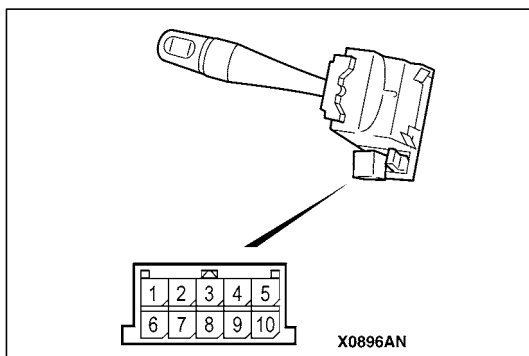

**WINDSHIELD INTERMITTENT WIPER INTERVAL ADJUSTING KNOB CHECK**

<R.H.drive vehicles>

Measure the resistance value at terminal numbers 4 and 6. The resistance value should rise smoothly from approximately 0 W (“FAST” position) to approximately 1 kW (“SLOW” position).

**NOTE**

The windshield washer switch and windshield wiper switch is integrated in the column-ECU, so can not be checked as an individual part. However, its operation can be checked by the input signal check. (GROUP 54B - Troubleshooting.)



# MARKS

## REMOVAL AND INSTALLATION

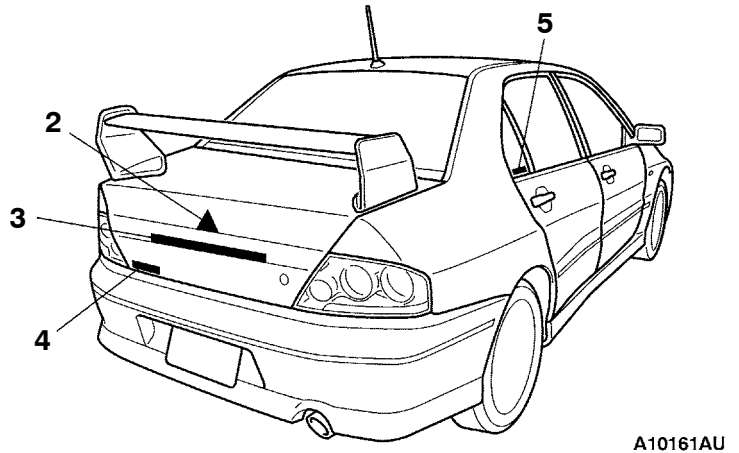
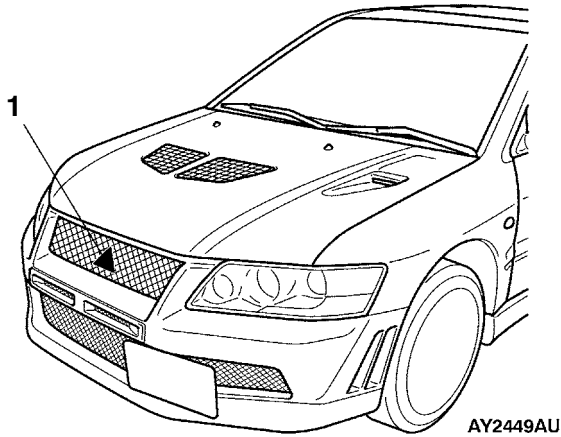

- ▶A◀ 1. Three-diamond mark  
 ▶A◀ 2. Three-diamond mark  
 ▶A◀ 3. Evolution-VII mark

- ▶A◀ 4. LANCER mark  
 ▶A◀ 5. RECARO decal <RS-II>

## INSTALLATION SERVICE POINT

▶A◀ ATTACHMENT OF EACH MARK

### 1. ATTACHED POSITION

(2) Three-diamond mark, (3) Evolution-VII mark

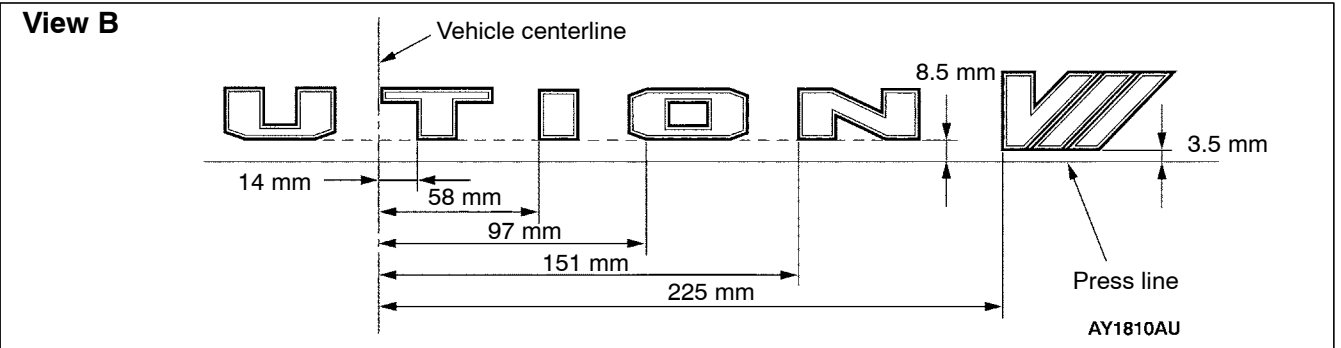
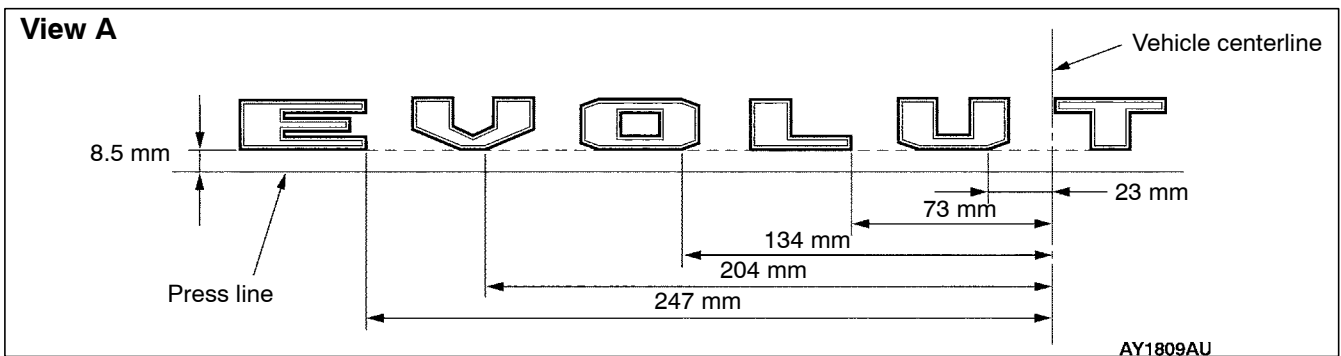
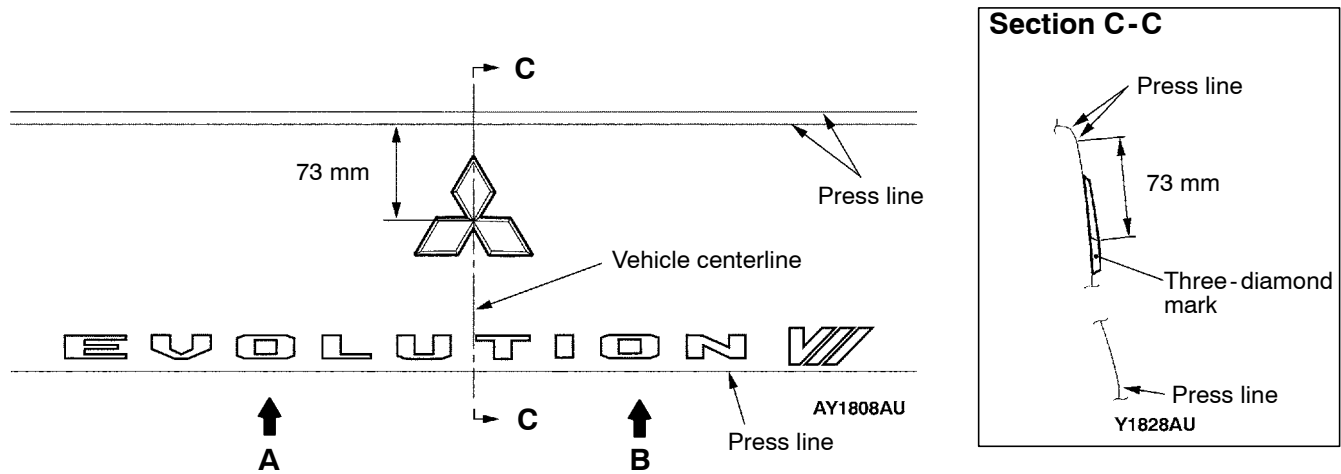

(4) Lancer mark

