

### Changing the oil filter

- Place a suitable pan under the engine.
- Remove the 4 screws ❶ and both oil filter covers.

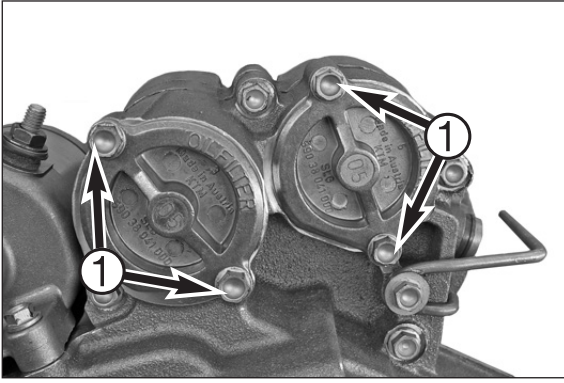

- Use circlip pliers to pull the oil filter inserts ❷ out of the housing.

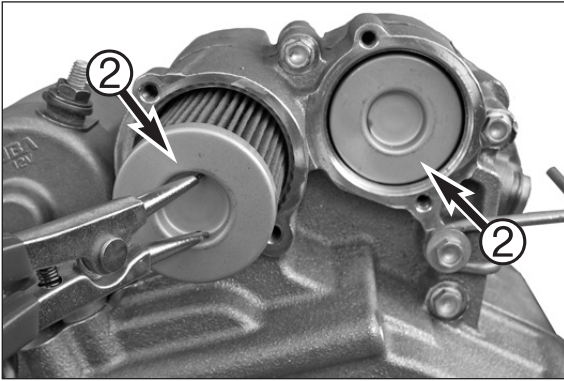

- Clean the oil filter cover ❸, the sealing areas on the O-rings and the engine case. Replace the O-rings in the oil filter cover.
- Soak new oil filters in fresh engine oil before installation.
- Install new oil filters. Insert the long oil filter in the front and the short oil filter in the back of the housing.
- Lightly oil the O-rings in the oil filter cover and install with cover ❹. Mount the screws and tighten to 6 Nm.

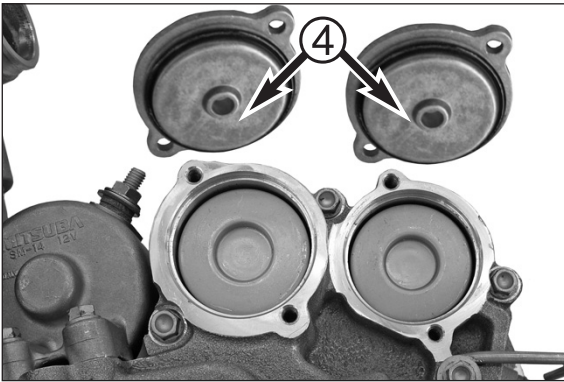

- Remove the screw cap ❺ on the clutch cover and add approx. 1.6 liters of fully-synthetic PS-4 Plus engine oil.

- Mount the screw cap ❺.

- Start the engine and check all screw caps and the oil filter cover for leaks.

- Finally, check the engine oil level and correct if necessary.

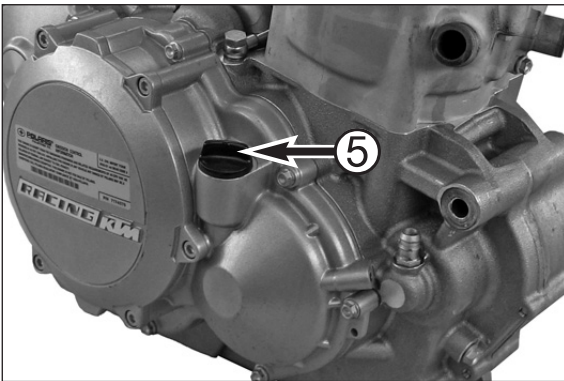

# BODY / STEERING / SUSPENSION

## CV Joint Service

### CAUTION

Complete disassembly of the CV joint is NOT recommended. The internal components are a precision fit and develop their own characteristic wear patterns. Intermixing the internal components could result in looseness, binding, and/or premature failure of the joint.

**IMPORTANT:** If the grease in the joint is obviously contaminated with water and/or dirt, the joint should be replaced.

Inspect the grease



1. Thoroughly clean the joint with an appropriate solvent and dry the joint to prevent any residual solvent from being left in the joint upon reassembly.
2. Visually inspect the joint for damage. Replace if needed.

**NOTE:** Shiny areas in ball tracks and on the cage spheres are normal. Do not replace CV joints because parts have polished surfaces. Replace CV joint only if components are cracked, broken, worn or otherwise unserviceable.

3. Slide the small boot clamp and boot (small end first) onto the drive shaft and position the boot in its groove machined in the shaft.

Install a NEW circlip on the end of the shaft.

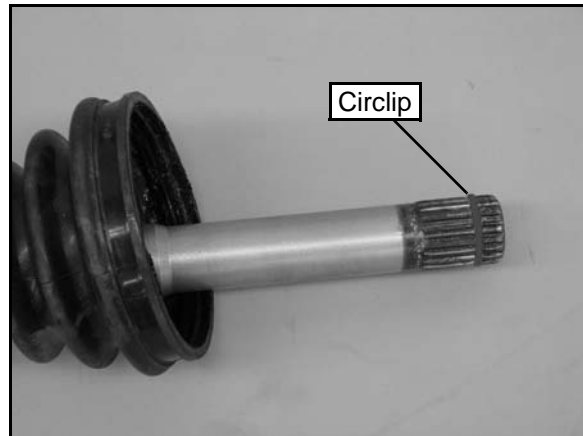

### CAUTION

The grease provided in the replacement kit is specially formulated for wear resistance and durability. DO NOT use substitutes or mix with other lubricants.

**NOTE:** The amount of grease that's provided with the boot kit is pre-measured, so use all the grease.

#### CV Boot Replacement Kit

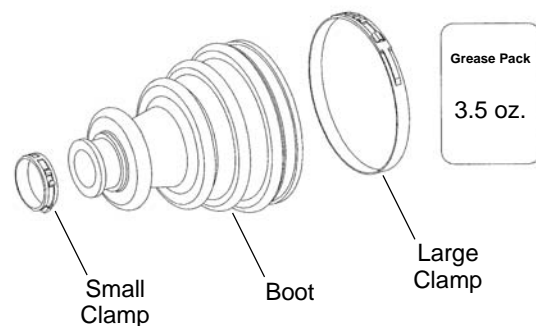

**CV Joint Grease  
Included with Boot Replacement Kit:  
3.5 oz. (99 g)**

4. Grease the inner and outer joint races. Fully compress the joint and push the drive shaft into the inner race of the CV joint.
5. Align the circlip with the lead-in chamfer.
6. Use a soft-faced hammer to assemble the shaft into the inner race of the CV joint. Tap on the joint until the shaft "clicks" into place.