

# Operation & Maintenance Manual

WEAM014400

# PC55MR-3

HYDRAULIC EXCAVATOR

SERIAL NUMBER

**PC55MR-3 F30003** and up



## WARNING

Unsafe use of this machine may cause serious injury or death. Operators and maintenance personnel must read this manual before operating or maintaining this machine.

This manual should be kept inside the cab for reference and periodically reviewed by all personnel who will come into contact with the machine.

ORIGINAL INSTRUCTIONS

**KOMATSU**  
*Utility*

# TABLE OF CONTENTS

## FOREWORD

<b>1.1</b>	<b>FOREWORD</b> .....	<b>1</b>
<b>1.2</b>	<b>INFORMATION ON SAFETY</b> .....	<b>2</b>
<b>1.3</b>	<b>INTRODUCTION</b> .....	<b>5</b>
1.3.1	INTENDED USE OF THE MACHINE .....	5
1.3.2	IMPROPER OR UNAUTHORIZED USES .....	5
1.3.3	MAIN CHARACTERISTICS .....	5
1.3.4	RUNNING-IN .....	6
1.3.5	POSITIONS AND DIRECTIONS OF THE MACHINE .....	7
<b>1.4</b>	<b>PRODUCT IDENTIFICATION</b> .....	<b>8</b>
1.4.1	MACHINE IDENTIFICATION PLATE AND PRODUCT IDENTIFICATION NUMBER (PIN) ...	8
1.4.1.1	MACHINE SERIAL NUMBER PLATE (according directive 2006/42/EC).....	8
1.4.2	ENGINE SERIAL NUMBER AND EXHAUST GAS EMISSION PLATE .....	9
1.4.3	CAB SERIAL NUMBER.....	9
1.4.4	HOUR METER .....	10
1.4.5	TABLE TO ENTER SERIAL NO. AND DISTRIBUTOR .....	11
1.4.6	DECLARATION OF CONFORMITY (for machines placed on the market as from 29 December 2009) .....	11
<b>1.5</b>	<b>KOMTRAX SYSTEM</b> .....	<b>12</b>
1.5.1	GENERAL PRECAUTIONS .....	12
	<b>TABLE OF CONTENTS</b> .....	<b>15</b>

## SAFETY AND ACCIDENT PREVENTION

<b>2.1</b>	<b>SAFETY, NOISE AND VIBRATION PLATES</b> .....	<b>24</b>
2.1.1	POSITION OF THE SAFETY PLATES .....	24
2.1.2	PICTOGRAMS AND RELEVANT MEANINGS.....	25
2.1.3	POSITION OF THE NOISE PLATES ON MACHINES WITH CAB .....	38
2.1.4	POSITION OF THE NOISE PLATES ON MACHINES WITH CANOPY .....	40
2.1.5	VIBRATIONS TO WHICH THE OPERATOR IS SUBJECTED .....	41
<b>2.2</b>	<b>GENERAL PRECAUTIONS</b> .....	<b>43</b>
2.2.1	GENERAL SAFETY RULES .....	43
2.2.2	HOW TO BEHAVE IN CASE OF ANOMALIES .....	43
2.2.3	SAFETY DEVICES AND GUARDS .....	43
2.2.4	CLOTHING AND PERSONAL PROTECTION ITEMS .....	43
2.2.5	UNAUTHORIZED MODIFICATIONS .....	44
2.2.6	LEAVING THE OPERATOR SEAT .....	44
2.2.7	EMERGENCY EXIT .....	45
2.2.8	GETTING ON AND OFF THE MACHINE .....	45
2.2.9	IT IS FORBIDDEN TO CLIMB ON THE EQUIPMENT .....	46
2.2.10	ARTICULATED PARTS.....	46
2.2.11	LIFTING OF PERSONNEL PROHIBITED.....	46
2.2.12	PREVENTING FIRES DUE TO FUEL AND OIL .....	46
2.2.13	PREVENTING BURNS .....	47
2.2.14	PREVENTING FIRES CAUSED BY ACCUMULATED INFLAMMABLE MATERIAL .....	47
2.2.15	FIRES CAUSED BY ELECTRICAL WIRING.....	47
2.2.16	HOW TO BEHAVE IN CASE OF FIRE.....	47
2.2.17	DETERGENT FOR THE WINDOWS .....	47

TABLE OF CONTENTS

2.2.18	PREVENTING DAMAGE DUE TO ASBESTOS POWDER .....	48
2.2.19	PREVENTING DAMAGE CAUSED BY THE WORK EQUIPMENT .....	48
2.2.20	FIRE EXTINGUISHERS AND FIRST AID KIT .....	48
2.2.21	PRECAUTIONS CONCERNING THE ROPS STRUCTURE.....	49
2.2.22	PRECAUTIONS CONCERNING THE CAB STRUCTURE .....	49
2.2.23	PRECAUTIONS CONCERNING THE EQUIPMENT.....	49
<b>2.3</b>	<b>PRECAUTIONS TO BE TAKEN BEFORE STARTING THE ENGINE .....</b>	<b>50</b>
2.3.1	SAFETY AT THE WORK SITE.....	50
2.3.2	FIRE PREVENTION .....	50
2.3.3	PRECAUTIONS CONCERNING THE OPERATOR SEAT .....	50
2.3.4	ROOM VENTILATION .....	51
2.3.5	PRECAUTIONS TO BE TAKEN FOR THE LIGHTS .....	51
2.3.6	CAB WINDOWS .....	51
2.3.7	CLEANING THE WINDOWS AND CHECKING THE WINDSHIELD WIPER BLADES.....	51
<b>2.4</b>	<b>PRECAUTIONS TO BE TAKEN WHEN WORKING.....</b>	<b>52</b>
2.4.1	STARTING THE ENGINE .....	52
2.4.2	CHECK THE DIRECTION BEFORE STARTING THE MACHINE .....	53
2.4.3	HAND SIGNALS .....	53
2.4.4	CHECKS FOR TRAVELLING IN REVERSE .....	58
2.4.5	MOVING THE MACHINE .....	58
2.4.6	MOVING ON SLOPES .....	59
2.4.7	WORKING ON SLOPES .....	60
2.4.8	UNAUTHORIZED OPERATIONS.....	60
2.4.9	PREVENTING ELECTROCUTION.....	62
2.4.10	VISIBILITY .....	63
2.4.11	WORKING ON ICY OR SNOW-COVERED SURFACES.....	63
2.4.12	PREVENTING DAMAGE CAUSED BY THE WORK EQUIPMENT .....	63
2.4.13	WORKING ON LOOSE GROUND .....	63
2.4.14	PARKING THE MACHINE .....	64
<b>2.5</b>	<b>TRANSPORTING THE MACHINE ON MOTOR VEHICLES.....</b>	<b>65</b>
2.5.1	LOADING AND UNLOADING THE MACHINE .....	65
2.5.2	TRANSPORTING THE MACHINE .....	65
<b>2.6</b>	<b>BATTERY .....</b>	<b>66</b>
2.6.1	PREVENTING RISKS THAT MAY BE DUE TO THE BATTERY .....	66
2.6.2	STARTING WITH BOOSTER CABLES .....	67
<b>2.7</b>	<b>PRECAUTIONS FOR THE REMOVAL OF THE MACHINE .....</b>	<b>68</b>
<b>2.8</b>	<b>PRECAUTIONS FOR MAINTENANCE.....</b>	<b>69</b>
2.8.1	WARNING PLATES .....	69
2.8.2	TOOLS .....	69
2.8.3	STABILITY.....	69
2.8.4	MAINTENANCE STAFF .....	69
2.8.5	EQUIPMENT .....	70
2.8.6	WORKING UNDER THE MACHINE .....	70
2.8.7	CLEANING THE MACHINE .....	70
2.8.8	USE OF THE ENGINE DURING MAINTENANCE .....	71
2.8.9	PERIODICAL CHANGE OF THE PARTS THAT ARE CRITICAL FOR SAFETY.....	71
2.8.10	REPAIR WELDS.....	71
2.8.11	STOP THE ENGINE BEFORE CARRYING OUT ANY MAINTENANCE OPERATION OR INSPECTION .....	72
2.8.12	BATTERY MAIN SWITCH PRECAUTIONS (if installed).....	72
2.8.13	SAFETY MEASURES TO OPEN (TILT) THE PLATFORM .....	73

2.8.14	RULES TO BE FOLLOWED WHEN REFUELLING OR ADDING OIL .....	74
2.8.15	CHECKING THE COOLANT LEVEL IN THE RADIATOR .....	74
2.8.16	USING LAMPS .....	74
2.8.17	PRECAUTIONS TO BE TAKEN WHEN HANDLING THE BATTERY AND THE ALTERNATOR .....	75
2.8.18	PRECAUTIONS CONCERNING THE STARTER .....	75
2.8.19	HANDLING HIGH-PRESSURE HOSES .....	76
2.8.20	PRECAUTIONS TO BE TAKEN WHEN HANDLING HIGH-PRESSURE OIL .....	76
2.8.21	PRECAUTIONS FOR MAINTENANCE OPERATIONS AT HIGH TEMPERATURES AND HIGH PRESSURE .....	76
2.8.22	PRECAUTIONS TO BE TAKEN WHEN USING HIGH-PRESSURE GREASE TO ADJUST THE TRACK TENSION .....	77
2.8.23	DO NOT REMOVE THE SHOCK ABSORBING SPRING FROM THE SHOCK ABSORBER UNIT .....	77
2.8.24	HYDRAULIC ACCUMULATOR AND GAS SPRING .....	77
2.8.25	COOLING FAN AND BELT .....	78
2.8.26	CHEMICAL HAZARD .....	78
2.8.27	WASTE MATERIALS .....	78
2.8.28	AIR CONDITIONER MAINTENANCE (if fitted) .....	78
2.8.29	COMPRESSED AIR .....	78
2.8.30	PRECAUTIONS TO BE TAKEN WHEN HANDLING TECHNOLOGICAL POLYMERS AND ELASTOMERS .....	79
2.8.31	PRECAUTIONS TO BE TAKEN WHEN USING SYNTHETIC BIODEGRADABLE OIL TYPE HEES .....	79
2.8.32	FINAL DISPOSAL OF THE MACHINE .....	79

## THE MACHINE AND ITS OPERATIONS

<b>3.1</b>	<b>MACHINE ILLUSTRATIONS .....</b>	<b>82</b>
3.1.1	OVERALL VIEW OF THE MACHINE .....	82
3.1.2	CONTROLS AND GAUGES .....	83
<b>3.2</b>	<b>INSTRUMENTS AND CONTROLS .....</b>	<b>84</b>
3.2.1	WARNING LIGHTS AND GAUGES .....	84
3.2.1.1	EMERGENCY WARNING LIGHTS .....	85
3.2.1.2	GAUGES .....	87
3.2.1.3	WARNING LIGHTS .....	89
3.2.2	SWITCHES AND PUSH BUTTONS .....	90
3.2.3	CONTROL LEVERS AND PEDALS .....	96
3.2.4	CAB (if provided) .....	103
3.2.4.1	WINDSCREEN (machines with cab) .....	103
3.2.4.2	SLIDING DOOR (machines with cab) .....	108
3.2.4.3	SIDE SLIDING WINDOW (machines with cab) .....	108
3.2.4.4	EMERGENCY EXIT HAMMER (machines with cab) .....	109
3.2.5	COVERS WITH LOCK .....	110
3.2.6	ENGINE HOOD .....	111
3.2.7	RADIATOR COVER .....	112
3.2.8	TANK COVER .....	113
3.2.9	TILTING THE CAB FLOOR .....	114
3.2.10	AUXILIARY POWER OUTLET .....	120
3.2.11	FUSES .....	120
3.2.12	MAIN FUSE .....	121
3.2.13	12V OUTLET FUSE .....	121

TABLE OF CONTENTS

3.2.14	AIR CONDITIONER (if installed) .....	122
3.2.14.1	AIR CONDITIONER CONTROL PANEL (if fitted) .....	124
3.2.15	TECHNICAL DOCUMENTATION COMPARTMENT .....	126
3.2.16	TOOL BOX .....	126
3.2.17	ASHTRAY Machine equipped with cab .....	126
3.2.18	GREASING PUMP SUPPORT .....	126
<b>3.3</b>	<b>USE OF THE MACHINE AND RELATED CONTROLS .....</b>	<b>127</b>
3.3.1	BEFORE STARTING THE ENGINE .....	127
3.3.1.1	VISUAL CHECKS .....	127
3.3.1.2	CHECKS TO BE CARRIED OUT BEFORE STARTING THE ENGINE .....	130
3.3.1.3	ADJUSTMENTS .....	137
3.3.1.4	OPERATIONS TO BE CARRIED OUT BEFORE STARTING THE ENGINE .....	141
3.3.1.5	STARTING THE ENGINE .....	143
3.3.2	AFTER STARTING THE ENGINE .....	146
3.3.2.1	RUNNING-IN .....	146
3.3.2.2	ENGINE STARTING CAPACITY AND NOISE LEVEL CHECK .....	146
3.3.2.3	ENGINE ACCELERATION AND DECELERATION CHECK .....	146
3.3.2.4	WARMING THE ENGINE .....	147
3.3.3	STOPPING THE ENGINE .....	149
3.3.4	HOW TO MOVE THE MACHINE .....	150
3.3.4.1	PRELIMINARY OPERATIONS TO BE CARRIED OUT BEFORE MOVING THE MACHINE .....	150
3.3.4.2	MOVING THE MACHINE FORWARD .....	150
3.3.4.3	MOVING THE MACHINE IN REVERSE .....	152
3.3.4.4	STOPPING THE MACHINE .....	153
3.3.5	STEERING THE MACHINE .....	154
3.3.5.1	STEERING (CHANGING DIRECTION) .....	154
3.3.6	TURRET ROTATION .....	156
3.3.7	WORK EQUIPMENT CONTROLS AND FUNCTIONS .....	157
3.3.8	UNAUTHORIZED OPERATIONS .....	159
3.3.9	PRECAUTIONS FOR USE .....	161
3.3.10	PRECAUTIONS TO BE TAKEN WHEN TRAVELLING ON SLOPES .....	163
3.3.11	GETTING THE MACHINE OUT OF MUD .....	165
3.3.12	POSSIBLE APPLICATIONS OF THE HYDRAULIC EXCAVATOR .....	166
3.3.13	CHANGING THE BUCKET .....	168
3.3.14	PARKING THE MACHINE .....	169
3.3.15	CHECKS TO BE CARRIED OUT BEFORE STOPPING THE ENGINE .....	170
3.3.16	CHECKS TO BE CARRIED OUT AFTER WORK .....	170
3.3.17	LOCKING THE MACHINE .....	171
3.3.18	RUBBER TRACKS (Machines equipped with rubber tracks only) .....	172
3.3.18.1	OPTIMAL USE OF THE RUBBER TRACKS .....	172
3.3.18.2	WARRANTY ON RUBBER TRACKS .....	172
3.3.18.3	USE OF THE RUBBER TRACKS .....	172
<b>3.4</b>	<b>TRANSPORTING THE MACHINE .....</b>	<b>177</b>
3.4.1	TRANSPORT PROCEDURE .....	177
3.4.2	LOADING AND UNLOADING THE MACHINE .....	177
3.4.3	LIFTING THE MACHINE .....	183
<b>3.5</b>	<b>USING THE MACHINE IN THE COLD SEASON .....</b>	<b>186</b>
3.5.1	PRECAUTIONS TO BE TAKEN WHEN USING THE MACHINE IN THE COLD SEASON .....	186
3.5.1.1	FUEL AND LUBRICANTS .....	186
3.5.1.2	COOLANT .....	186
3.5.1.3	BATTERY .....	187
3.5.2	HEATING THE CAB .....	188

3.5.3	PRECAUTIONS TO BE TAKEN EVERY DAY AT THE END OF WORK.....	188
3.5.4	HOW TO PROCEED AT THE END OF THE COLD SEASON .....	188
<b>3.6</b>	<b>LONG PERIODS OF INACTIVITY .....</b>	<b>189</b>
3.6.1	BEFORE A PERIOD OF INACTIVITY .....	189
3.6.2	DURING A PERIOD OF INACTIVITY .....	189
3.6.3	AFTER A PERIOD OF INACTIVITY .....	190
3.6.4	RECOMMENDATIONS FOR MACHINES EQUIPPED WITH KOMTRAX SYSTEM DURING LONG PERIODS OF INACTIVITY .....	190
3.6.5	ALLOWED AMBIENT TEMPERATURE RANGE DURING THE OPERATION AND STORAGE OF THE MACHINE FOR A LONG TIME .....	190
<b>3.7</b>	<b>TROUBLESHOOTING .....</b>	<b>191</b>
3.7.1	IF FUEL RUNS OUT COMPLETELY .....	191
3.7.2	OCCURRENCES THAT ARE NOT FAILURES .....	191
3.7.3	REMOVING THE MACHINE .....	191
3.7.4	PRECAUTIONS TO BE TAKEN WHEN WORKING IN PARTICULAR CONDITIONS .....	192
3.7.5	IF THE BATTERY IS DOWN.....	192
3.7.5.1	REMOVING AND INSTALLING THE BATTERY .....	193
3.7.5.2	CHARGING THE BATTERY .....	193
3.7.5.3	STARTING WITH BOOSTER CABLES .....	194
3.7.6	OTHER TROUBLES.....	196
3.7.6.1	ELECTRICAL SYSTEM .....	196
3.7.6.2	FRAME.....	197
3.7.6.3	ENGINE .....	197

## MAINTENANCE

<b>4.1</b>	<b>GUIDE TO MAINTENANCE.....</b>	<b>200</b>
<b>4.2</b>	<b>MAINTENANCE NOTES.....</b>	<b>202</b>
4.2.1	OIL, FUEL AND COOLANT.....	202
4.2.1.1	OIL .....	202
4.2.1.2	FUEL .....	203
4.2.1.3	COOLANT .....	203
4.2.1.4	GREASE .....	203
4.2.1.5	KOWA (KOMATSU OIL WEAR ANALYSIS).....	204
4.2.1.6	STORING OIL AND FUEL .....	205
4.2.1.7	FILTERS .....	205
4.2.2	NOTES ON THE MAINTENANCE OF THE ELECTRICAL SYSTEM .....	206
4.2.3	NOTES ON THE MAINTENANCE OF THE HYDRAULIC SYSTEM.....	206
4.2.4	MAINTENANCE NOTES REGARDING LUBRICATION .....	206
<b>4.3</b>	<b>PARTS SUBJECT TO WEAR.....</b>	<b>207</b>
4.3.1	LIST OF THE PARTS SUBJECT TO WEAR.....	207
<b>4.4</b>	<b>FUEL, COOLANT AND LUBRICANTS.....</b>	<b>208</b>
4.4.1	COOLANT .....	210
4.4.2	APPROVED SYNTHETIC BIODEGRADABLE LUBRICANTS TYPE HEES .....	211
<b>4.5</b>	<b>TIGHTENING TORQUES.....</b>	<b>212</b>
4.5.1	STANDARD TIGHTENING TORQUES FOR SCREWS AND NUTS .....	212
4.5.2	STANDARD TIGHTENING TORQUES FOR FLEXIBLE HOSES .....	213
<b>4.6</b>	<b>LUBRICATION.....</b>	<b>214</b>
4.6.1	LUBRICATION DIAGRAM.....	214
<b>4.7</b>	<b>PERIODICAL CHANGE OF SAFETY-RELATED COMPONENTS.....</b>	<b>215</b>
4.7.1	SAFETY-RELATED PARTS.....	216
<b>4.8</b>	<b>MAINTENANCE PLAN.....</b>	<b>217</b>

TABLE OF CONTENTS

4.8.1	MAINTENANCE PLAN .....	217
4.8.2	MAINTENANCE INTERVALS IN CASE OF USE OF THE HYDRAULIC BREAKER.....	219
4.8.2.a	CHANGING THE HYDRAULIC OIL FILTER.....	219
4.8.2.b	CHANGING THE HYDRAULIC OIL .....	219
<b>4.9</b>	<b>MAINTENANCE PROCEDURES .....</b>	<b>220</b>
4.9.1	WHEN REQUIRED.....	220
4.9.1.a	CHECKING, CLEANING OR CHANGING THE AIR FILTER CARTRIDGE.....	220
4.9.1.b	CAB AIR FILTER CHECK AND CLEANING (machines with cab).....	222
4.9.1.c	BATTERY ELECTROLYTE LEVEL CHECK .....	223
4.9.1.d	CLEANING THE WATER SEPARATOR FILTER .....	225
4.9.1.e	DRAINING THE FUEL TANK.....	226
4.9.1.f	SHOE FIXING SCREWS CHECK AND TIGHTENING .....	227
4.9.1.g	CHECKING AND ADJUSTING THE STEEL TRACK TENSION.....	227
4.9.1.h	CHECKING THE RUBBER TRACKS.....	230
4.9.1.i	CHECKING AND ADJUSTING THE RUBBER TRACK TENSION .....	232
4.9.1.j	CHANGING THE RUBBER TRACKS .....	234
4.9.1.k	BUCKET TEETH REPLACEMENT .....	237
4.9.1.l	CHECKING THE DETERGENT LEVEL IN THE WINDSHIELD WASHER RESERVOIR (machine with cab) .....	238
4.9.1.m	CHECKING, CLEANING AND LUBRICATING THE GUIDE OF THE CAB SLIDING DOOR.....	239
4.9.1.n	LUBRICATION .....	240
4.9.1.o	BLEEDING THE HYDRAULIC SYSTEM .....	241
4.9.1.p	AIR CONDITIONER REFRIGERANT GAS CHECK (if fitted) .....	242
4.9.2	CHECKS TO BE CARRIED OUT BEFORE STARTING THE ENGINE .....	243
4.9.3	MAINTENANCE AFTER THE FIRST 50 HOURS OF OPERATION (Only for machines in which synthetic biodegradable oil type HEES is used).....	243
4.9.4	MAINTENANCE EVERY 100 HOURS OF OPERATION .....	244
4.9.4.a	LUBRICATION .....	244
4.9.5	MAINTENANCE EVERY 250 HOURS OF OPERATION .....	247
4.9.5.a	CHECKING AND ADJUSTING THE AIR CONDITIONER COMPRESSOR BELT TENSION (if installed).....	247
4.9.6	MAINTENANCE AFTER THE FIRST 500 HOURS OF OPERATION (Only for machines in which synthetic biodegradable oil type HEES is used).....	248
4.9.7	MAINTENANCE EVERY 500 HOURS OF OPERATION .....	249
4.9.7.a	CHANGING THE ENGINE OIL AND THE ENGINE OIL FILTER CARTRIDGE .....	249
4.9.7.b	CHANGING THE FUEL FILTER CARTRIDGE .....	250
4.9.7.c	CHECKING THE OIL LEVEL IN THE FINAL REDUCTION GEARS .....	252
4.9.7.d	RADIATOR FINS, EXCHANGER AND FUEL COOLANT CHECK AND CLEANING.....	253
4.9.7.e	CHECKING AND ADJUSTING THE FAN BELT TENSION .....	254
4.9.7.f	CHECK THE GREASE LEVEL OF THE OSCILLATING PINION AND ADD GREASE.....	255
4.9.7.g	DRAINING THE HYDRAULIC OIL TANK (Only for machines in which synthetic biodegradable oil type HEES is used) .....	256
4.9.7.h	AIR CONDITIONER CONDENSER FINS CHECK AND CLEANING (if fitted).....	257
4.9.7.i	CLEANING THE INSIDE AND OUTSIDE FILTERS OF THE AIR CONDITIONER (if installed).....	258
4.9.8	MAINTENANCE EVERY 1000 HOURS OF OPERATION .....	259
4.9.8.a	CHANGING THE HYDRAULIC OIL FILTER CARTRIDGE.....	259
4.9.8.b	CHANGING THE OIL IN THE FINAL REDUCTION GEARS .....	261
4.9.8.c	CHECKING AND ADJUSTING THE ENGINE VALVE CLEARANCE .....	261
4.9.9	MAINTENANCE EVERY 1500 HOURS OF OPERATION .....	262
4.9.9.a	FUEL INJECTION SYSTEM CHECK AND CLEANING .....	262
4.9.9.b	ENGINE CASING BREATHER PIPE CHECK .....	262

4.9.10 MAINTENANCE EVERY 2000 HOURS OF OPERATION ..... 263

    4.9.10.a CHANGING THE OIL IN THE HYDRAULIC TANK AND  
            CLEANING THE FILTER ..... 263

    4.9.10.b CHANGING THE COOLANT ..... 266

    4.9.10.c CHECKING THE ALTERNATOR AND THE STARTER ..... 267

    4.9.10.d NITROGEN LOADING PRESSURE CHECK IN THE ACCUMULATOR  
            (FOR THE CONTROL CIRCUIT)..... 268

**4.10 FINAL DISPOSAL OF THE MACHINE ..... 271**

**TECHNICAL SPECIFICATIONS**

**5.1 TECHNICAL SPECIFICATIONS ..... 274**

**5.2 LIFTING CAPACITIES ..... 276**

    5.2.1 LIFTING CAPACITIES (WITH CANOPY)..... 276

    5.2.2 LIFTING CAPACITIES (WITH CAB) ..... 278

**AUTHORIZED OPTIONAL EQUIPMENT**

**6.1 GENERAL PRECAUTIONS FOR SAFETY ..... 282**

    6.1.1 PRECAUTIONS WHEN SELECTING ..... 282

    6.1.2 READ THE INSTRUCTION MANUAL THOROUGHLY ..... 282

    6.1.3 PRECAUTIONS WHEN REMOVING OR INSTALLING..... 282

    6.1.4 PRECAUTIONS WHEN USING ..... 283

**6.2 SPECIFICATIONS..... 284**

    6.2.1 ARM-PIN INFORMATION ..... 284

**6.3 GUIDE TO USE THE ACCESSORIES..... 285**

    6.3.1 COMBINATIONS OF WORK EQUIPMENT ..... 285

    6.3.2 ATTACHMENT CONFIGURATION..... 285

**6.4 MACHINE CONFIGURATION FOR THE INSTALLATION OF ATTACHMENTS ..... 287**

    6.4.1 POSITION OF THE DEVICES ..... 287

    6.4.2 HYDRAULIC CIRCUIT ..... 289

        6.4.2.1 INSTALLING AND CONNECTING THE EQUIPMENT ..... 289

        6.4.2.2 MAINTENANCE ..... 289

        6.4.2.3 BLEEDING ..... 290

    6.4.3 OPERATING THE EQUIPMENT ..... 291

    6.4.4 LONG PERIODS OF INACTIVITY ..... 292

**6.5 PREPARATION FOR EQUIPMENT INSTALLATION  
    (only for machines with proportional controls) ..... 293**

    6.5.1 POSITION OF THE DEVICES ..... 293

    6.5.2 HYDRAULIC CIRCUIT ..... 298

        6.5.2.1 INSTALLING AND CONNECTING THE EQUIPMENT ..... 298

        6.5.2.2 MAINTENANCE ..... 298

        6.5.2.3 BLEEDING ..... 299

    6.5.3 ACCESSORIES ACTIVATION ..... 300

        6.5.3.1 USING THE HYDRAULIC BREAKER..... 300

        6.5.3.2 USE OF GENERIC EQUIPMENT SUCH AS THE CRUSHER ..... 301

        6.5.3.3 OIL FLOW ADJUSTMENT ..... 302

    6.5.4 LONG PERIODS OF INACTIVITY ..... 304

    6.5.5 SPECIFICATIONS..... 304

    6.5.6 OTHER TROUBLES..... 305

        6.5.6.1 ELECTRICAL SYSTEM ..... 305

        6.5.6.2 ELECTRONIC CONTROL SYSTEM..... 305



TABLE OF CONTENTS

<b>6.6</b>	<b>AUTO-DECELERATION .....</b>	<b>307</b>
6.6.1	GENERAL OVERVIEW OF THE MACHINE .....	307
6.6.1.1	CONTROLS AND GAUGES .....	307
6.6.2	TRANSPORTING THE MACHINE .....	309
6.6.2.1	LOADING AND UNLOADING THE MACHINE .....	309
6.6.3	OTHER TROUBLES.....	314
<b>6.7</b>	<b>PRECAUTIONS TO BE TAKEN WHEN USING OPTIONAL EQUIPMENT .....</b>	<b>315</b>
6.7.1	HYDRAULIC BREAKER.....	315

### 3.1.2 CONTROLS AND GAUGES

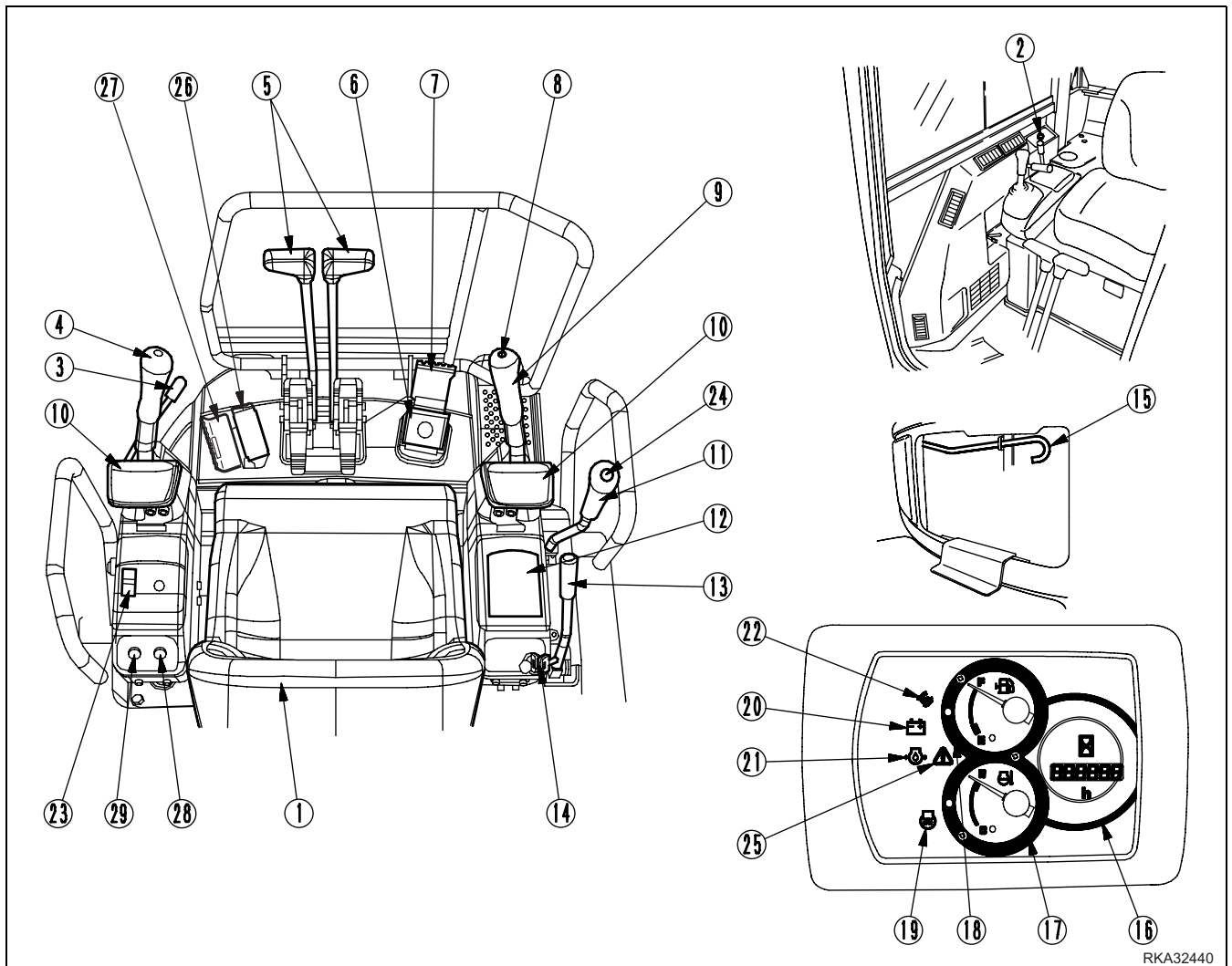

- |  |   |
|--|---|
| (1) Operator seat                          | (16) Hour meter   |
| (2) Heating switch (machines with cab)     | (17) Engine coolant temperature indicator               |
| (3) Control locking lever (safety lever)   | (18) Fuel level indicator                               |
| (4) Left work equipment control lever      | (19) Engine preheating warning light                    |
| (5) Travel levers (equipped with pedal)    | (20) Battery charge level warning light                 |
| (6) Boom swing control pedal               | (21) Engine oil pressure warning light                  |
| (7) Pedal locking device                   | (22) Travel speed increase warning light                |
| (8) Horn                                   | (23) Working lights switch                              |
| (9) Right work equipment control lever     | (24) Travel speed selection switch                      |
| (10) Arm                                   | (25) Electrical system control warning light (optional) |
| (11) Blade control lever                   | (26) Optional equipment control pedal                   |
| (12) Warning lights and indicators display | (27) Pedal locking device                               |
| (13) Accelerator lever                     | (28) Boom overload alarm switch (if installed)          |
| (14) Ignition switch                       | (29) Revolving light switch (if installed)              |
| (15) Cab floor locking lever               |   |

**LUBRICATION OF THE CYLINDER BASIC PIN BOOM SWING**

1. Open the engine hood and the radiator cover. For further details, see "3.2.7 RADIATOR COVER".
2. Loosen the screws (1) and remove the cover (2).
3. Carefully clean the grease nipple (3) located on the boom swing cylinder base and inject the grease indicated in the table of lubricants using the grease gun (see ".4.4 FUEL, COOLANT AND LUBRICANTS").
4. After greasing, remove each grease stain spilled and refit cover (2).

(1) 1st boom swing cylinder base pin (1 point)

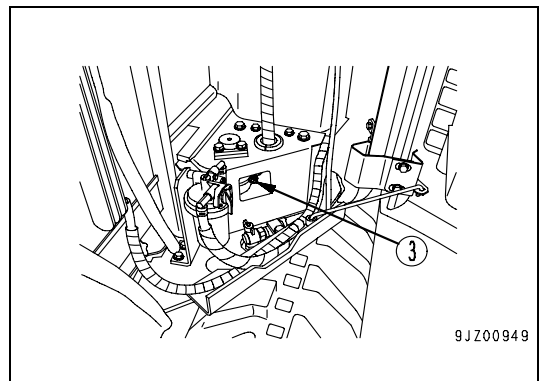
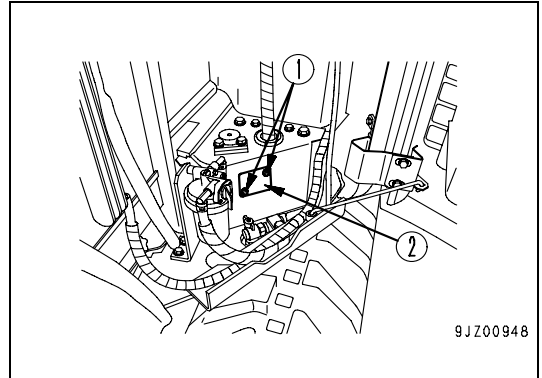

**LUBRICATING THE WORK EQUIPMENT**

**IMPORTANT**

● After carrying out digging operations with the equipment immersed in water, always lubricate the pins that have been in contact with water..

1. Position the machine as shown in the figure, lower the work equipment to the ground and stop the engine.
2. Carefully clean the grease nipples listed below, and inject the grease indicated in the lubricant chart using a grease pump (see"4.4 FUEL, COOLANT AND LUBRICANTS").
3. After greasing, remove any trace of grease.

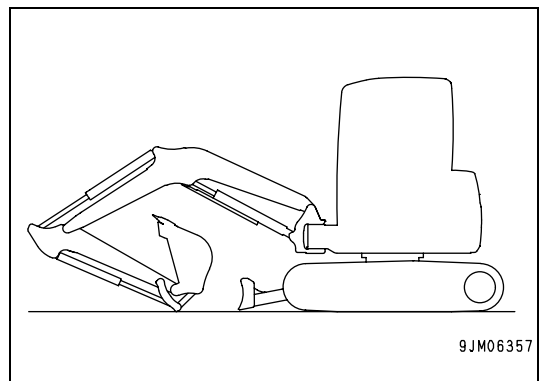

- (1) Bucket-link connection pins (1 point)
- (2) Arm–bucket connection pin (1 point)
- (3) Arm–link connection pin (1 point)
- (4) Bucket cylinder rod end (1 point)
- (5) Link connection pin (1 point)

